

Lit in red : Sleep mode
(Continuously pressing)

Design Information
Machine Setting
Error Stack

Design Input, Data Set
Memory Delete

AC/AS, Needle Bar Selection
Data Edit, Offset

Frame Back/Forward
Frame Setting

Trace, Manual Operation

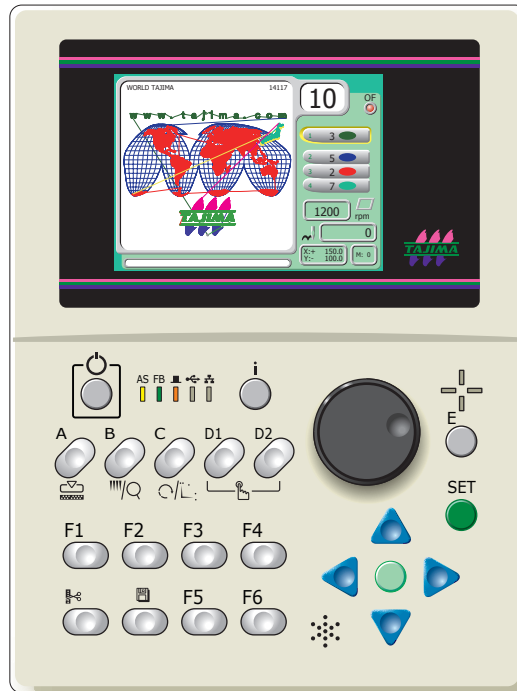

Select the design or the settings
Maximum operation speed
Move The Frame

End, Suspend
Switch of frame travel direction

Decision, Execute

Move the frame
Select item by using up/down key
Speed switching
(High speed/Low speed)

BASIC OPERATION

1 Reading Design (Data Input)

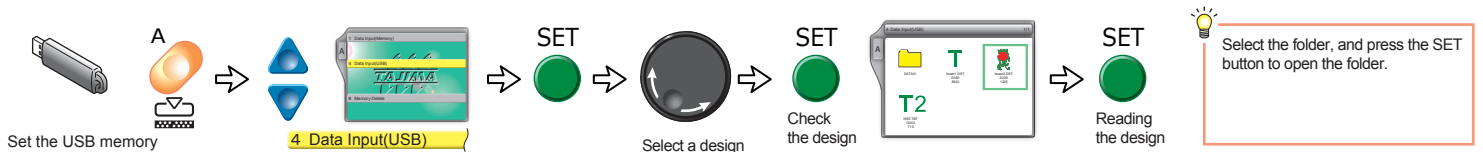

2 Preparation of Embroidering (Data set)

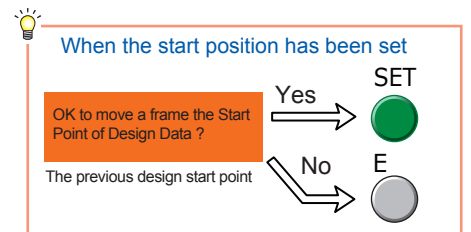
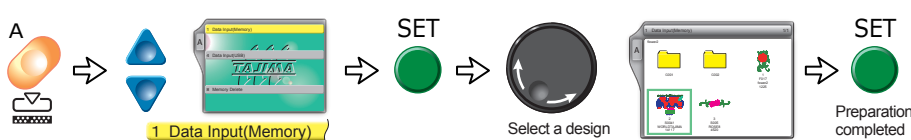

3 Auto Stitch Type Selection

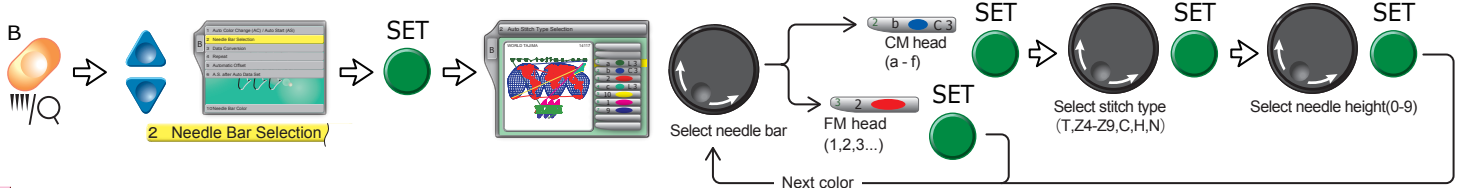

4 Move The Frame

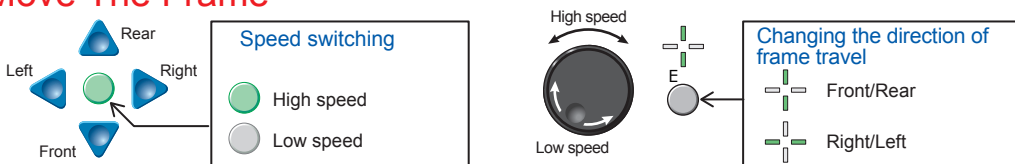

Lightbulb: When the start position of design has not been set, decide the position.

5 Trace

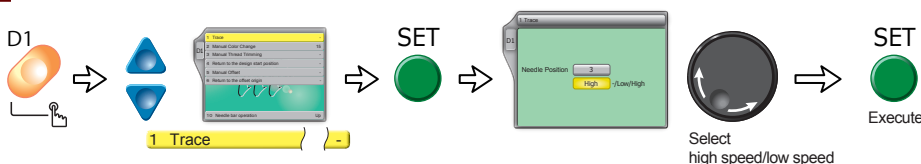

Lightbulb: When the design data does not fit into the embroidery space by performing Trace confirmation, change the start position.

6 Start Operation



COMMONLY USED FUNCTIONS

1 Repair Stitches (Stitch Back)

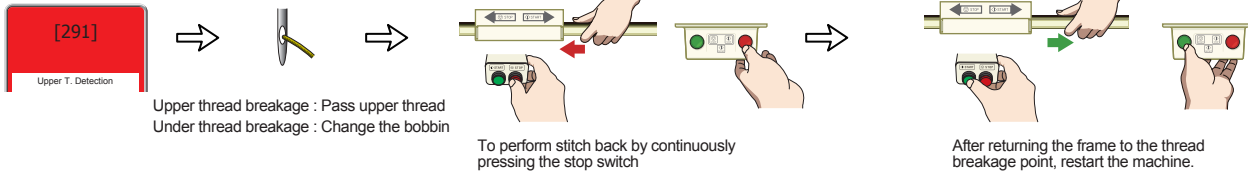

2 Auto Color Change (AC) / Auto Start (AS)

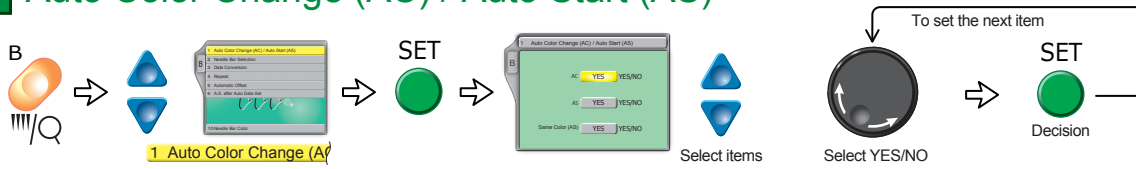

3 Design Information / Machine Setting / Error Stack

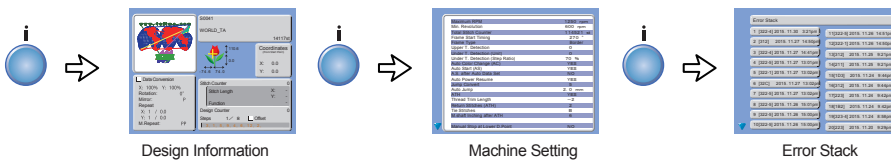

4 Manual Color Change

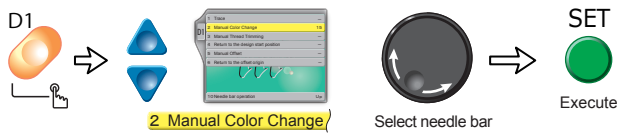

5 Manual Thread Trimming



6 Manual Offset



To return the moved frame to the original position

7 Automatic Offset

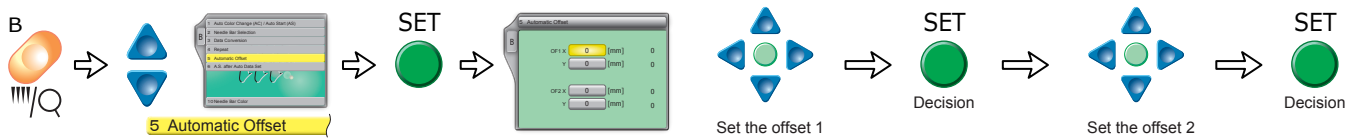

8 Memory Delete

