

BASIC EMBROIDERY OPERATION

TLMX SERIES



Table of contents

1. Turn ON the power	2
2. Thread passing, fabric setting.....	4
3. Registration of a design in the machine memory.....	10
4. Decision of an embroidery design, Color Change Sequence	18
5. Decision of the design start position	28
6. Check items before embroidering	35
7. Embroidery starts.....	41

1. Turn ON the power

 CAUTION	
⊘ Do not turn ON the machine power in the state that the USB memory is connected to the operation panel except when installing the software in the machine. The system sometimes may not start up.	

1-1. Power switch

There are following types of the power switch depending on the model.

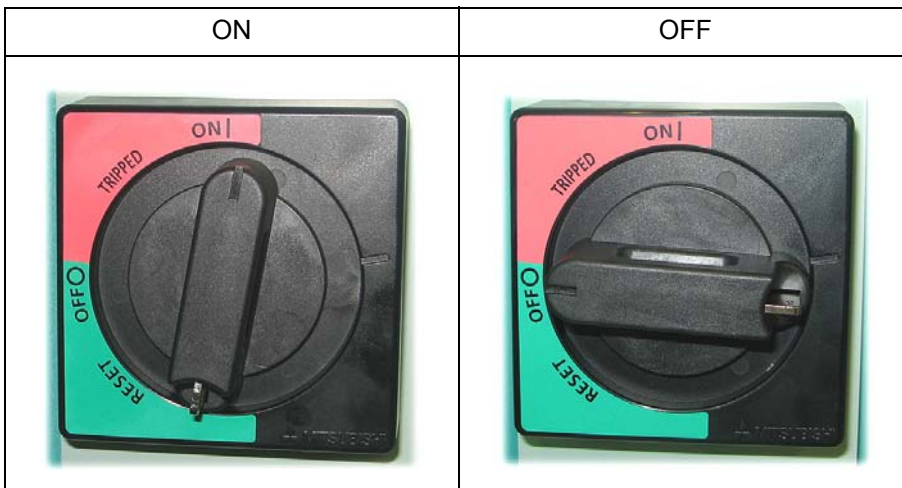
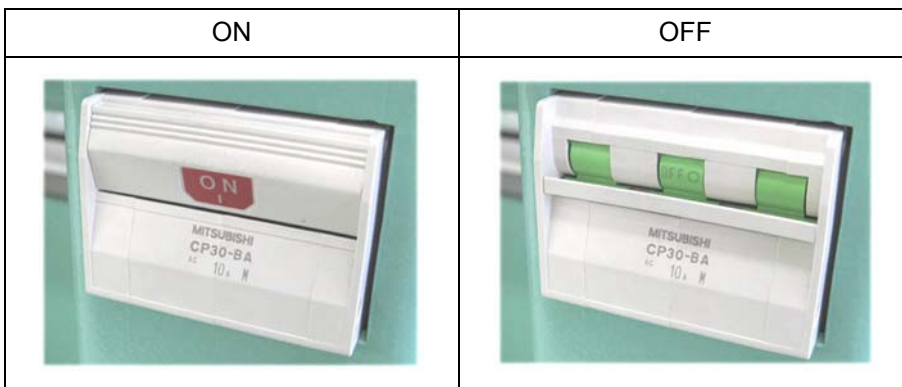

This type can be locked.

Turn ON the power

[When locking]

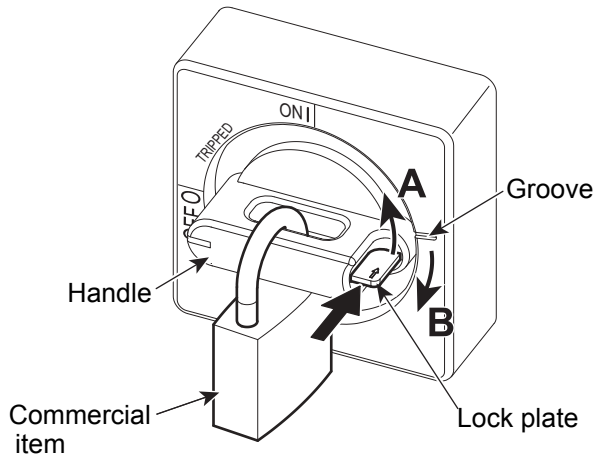

- (1) Turn the handle toward direction A to the position of the groove.
- (2) Push the lock plate to the direction indicated by a big arrow and return the handle to the direction B (the original position).
- (3) Lock.

1-2. Turn ON the power

After turning on the power, the screen will switch as the figure below. Wait for a while until the power starts up.

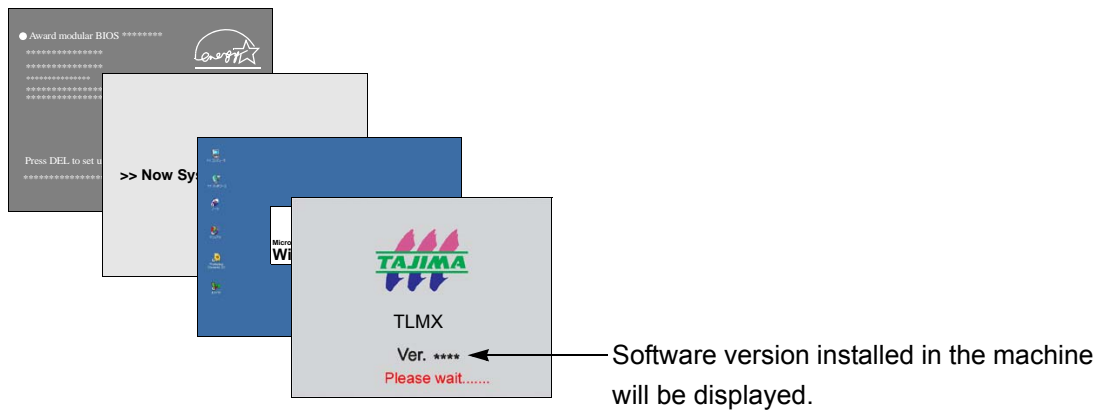

Main screen

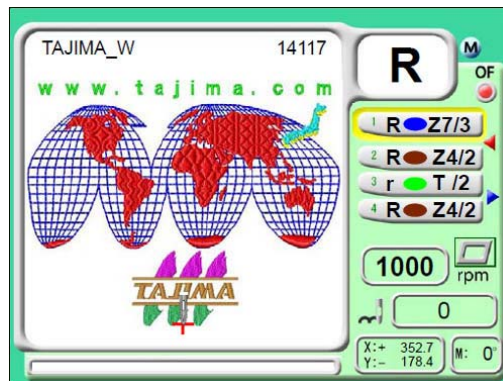

2. Thread passing, fabric setting

2-1. Pass the thread.

2-1-1. FM head

Threading at tension part (indicated by arrows) affects finishing of embroidering. Therefore, thread correctly.

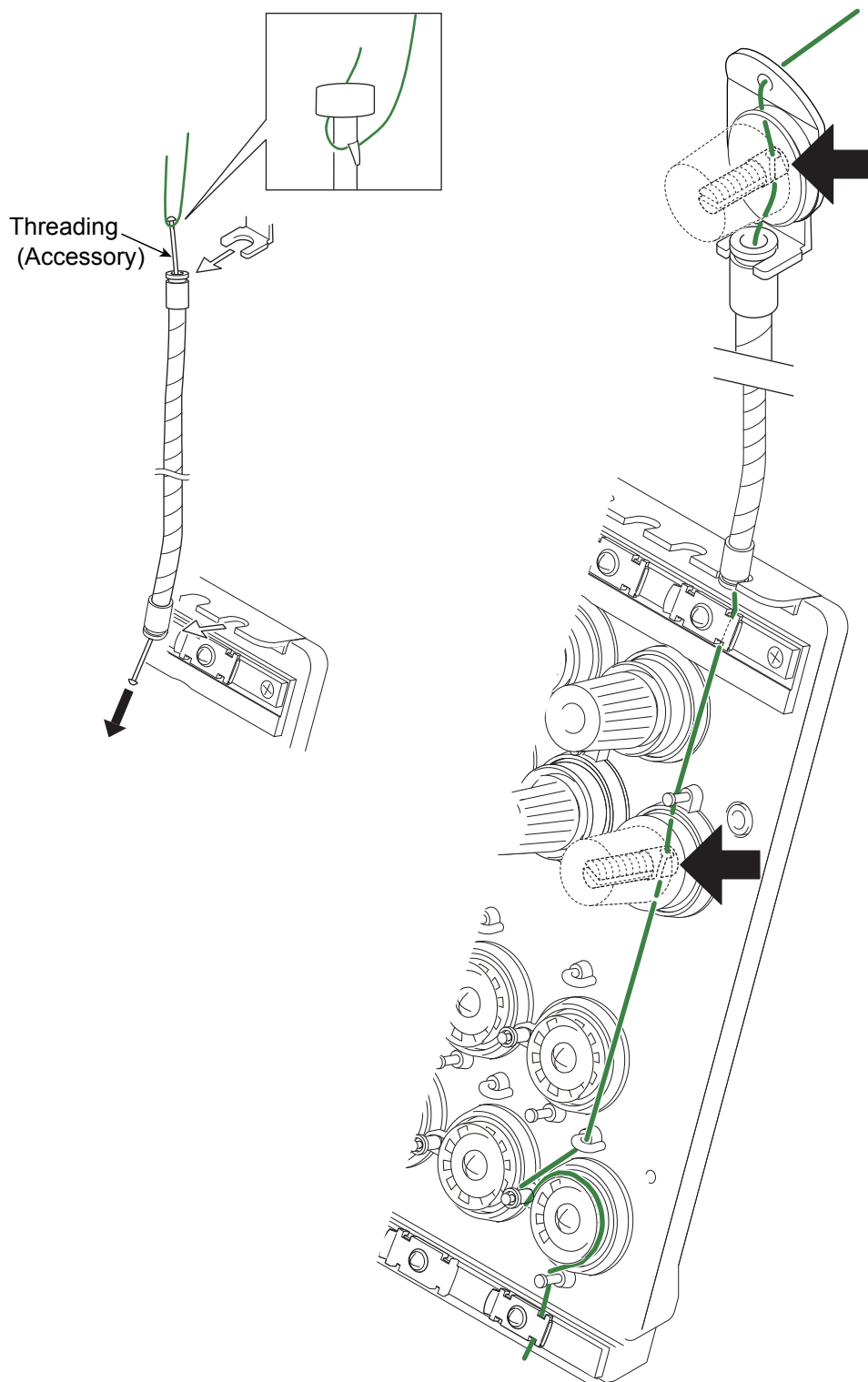

! CAUTION

- ! Pass the thread to the thread take-up spring and the upper thread lock surely. Otherwise thread breakage would be caused or the thread tension would be affected badly.
- ! Return the adjusting lever to the original position after passing the thread. Otherwise thread breakage would be caused or the thread tension would be affected badly.

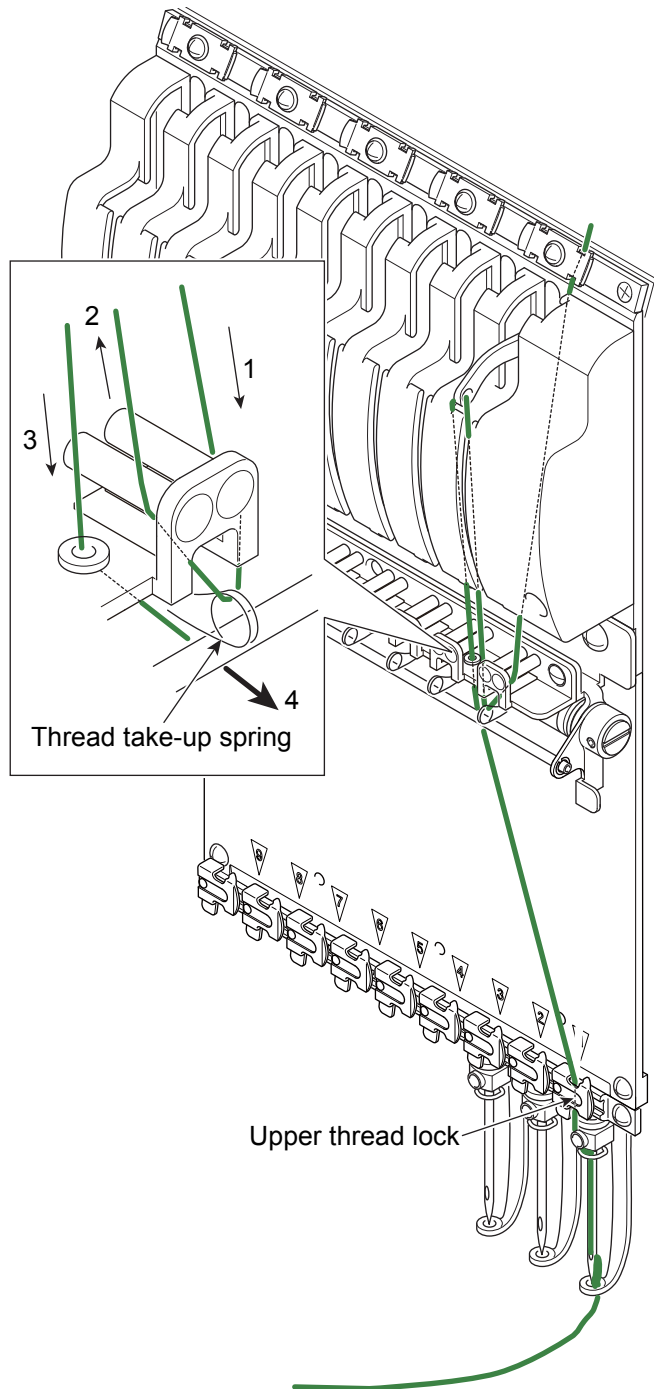

How to use adjusting lever

(1) Raise the lever.

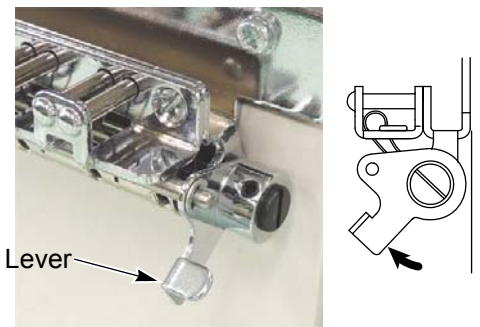

(2) Pass the thread.

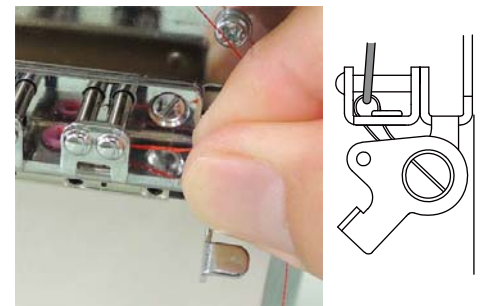

(3) After threading, return the lever. (The screw faces to the front.)

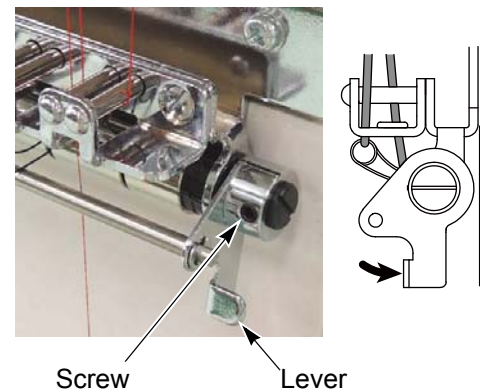

2-1-2. LM head

Threading at tension part (indicated by arrows) affects finishing of embroidering. Therefore, thread correctly.

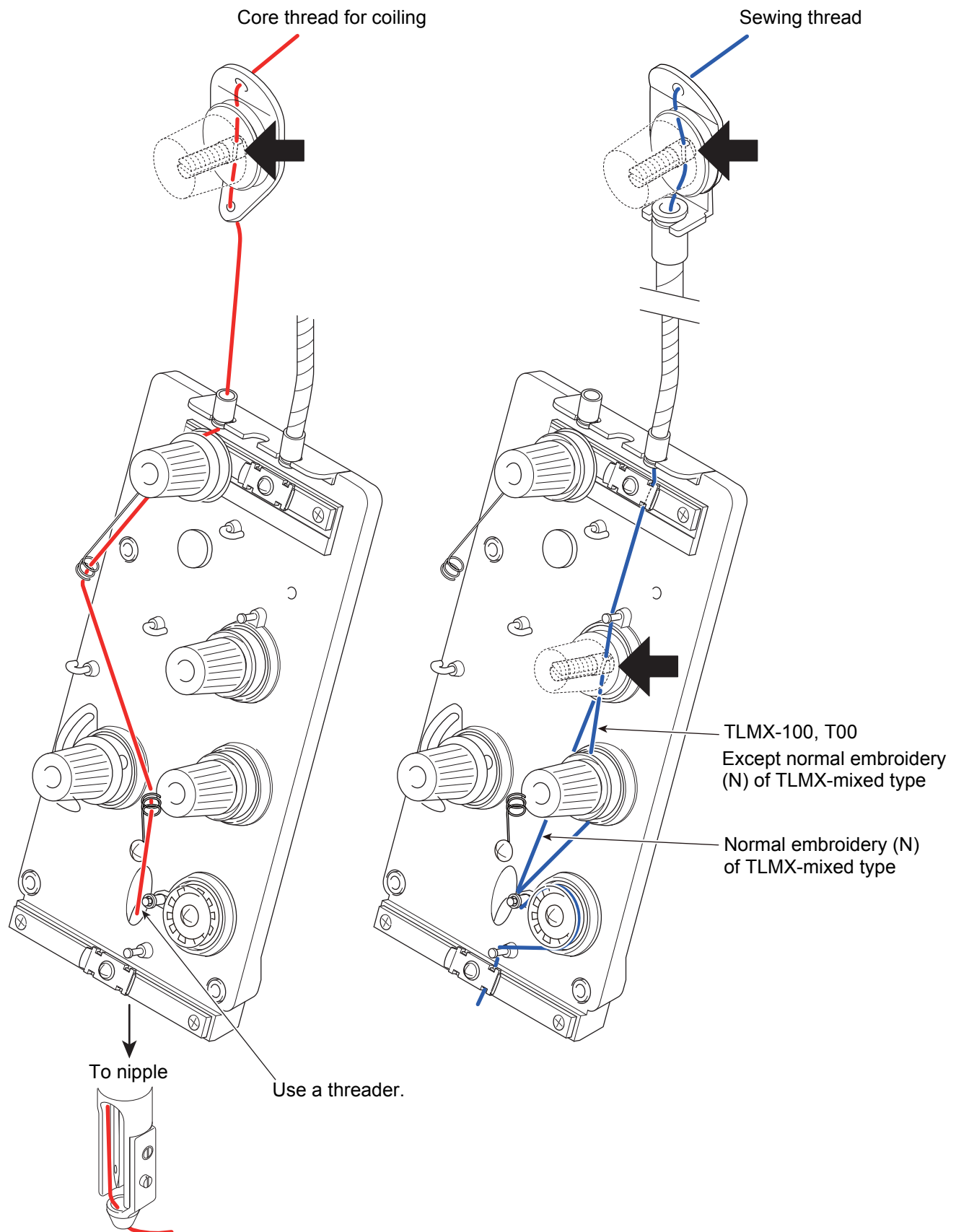

! CAUTION

- !** Pass the thread to the thread take-up spring surely. Otherwise it would cause the thread breakage or affect the thread tension badly.
- !** Return the adjusting lever to the original position after passing the thread. Otherwise thread breakage would be caused or the thread tension would be affected badly.

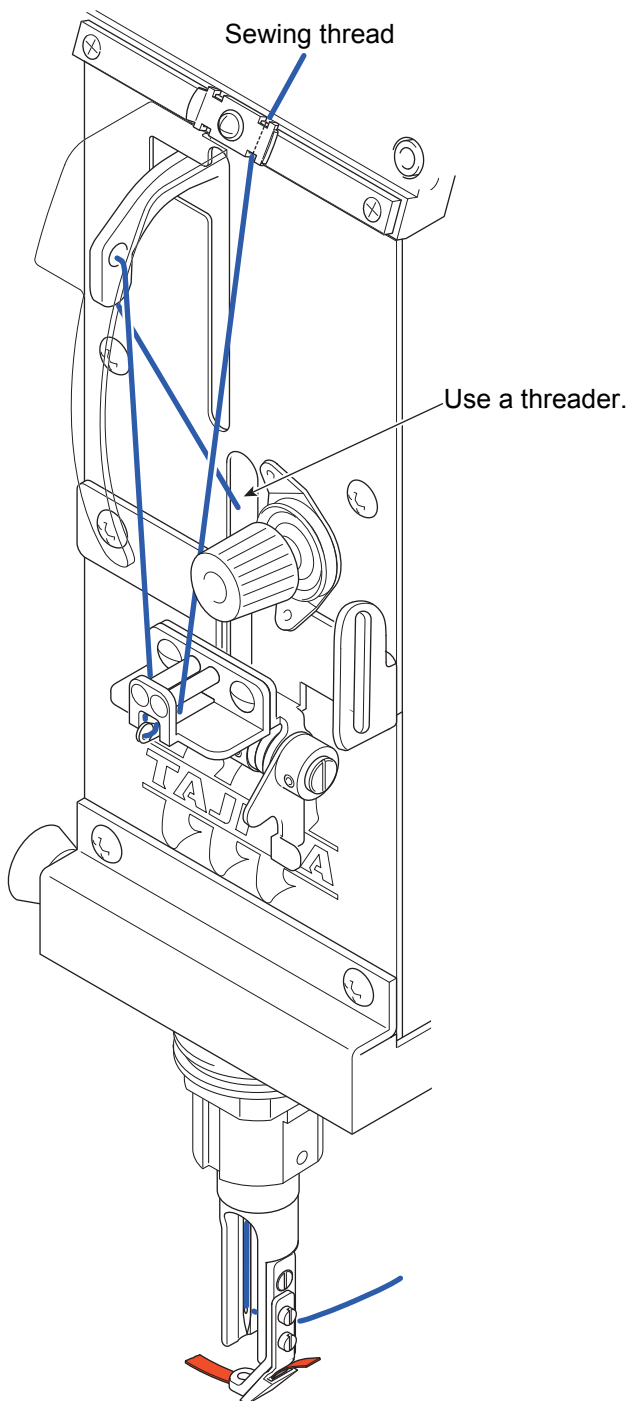

How to use adjusting lever

(1) Raise the lever.

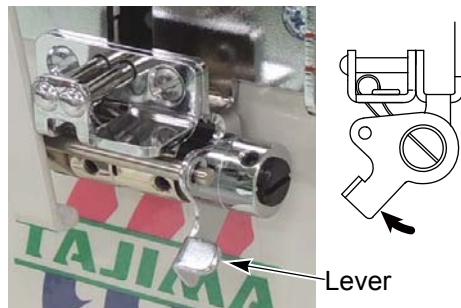

(2) Pass the thread.

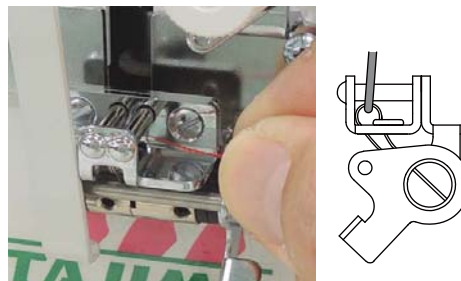

(3) After threading, return the lever. (The screw faces to the front.)

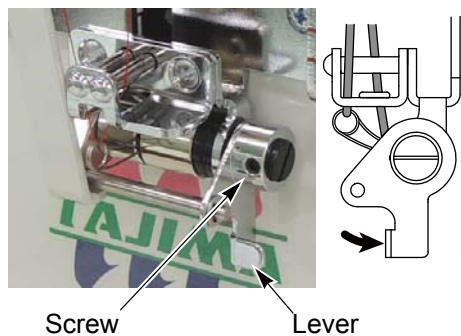

If you want a stronger thread tension, pass the thread as shown in the figure below.

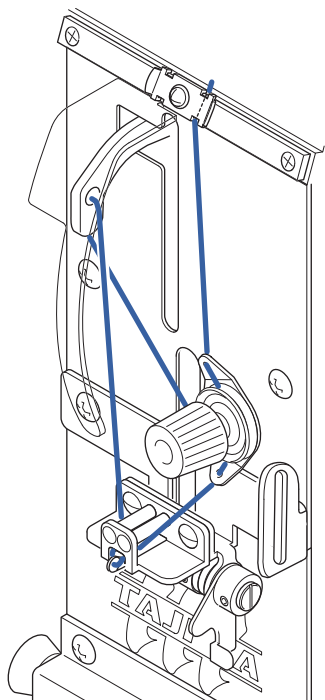

If you want to tighten the thread tension more strongly, attach the take-up lever adjuster by using the screws as shown in figure A. The attaching position of take-up adjuster differs depending on the type of rotary hook.

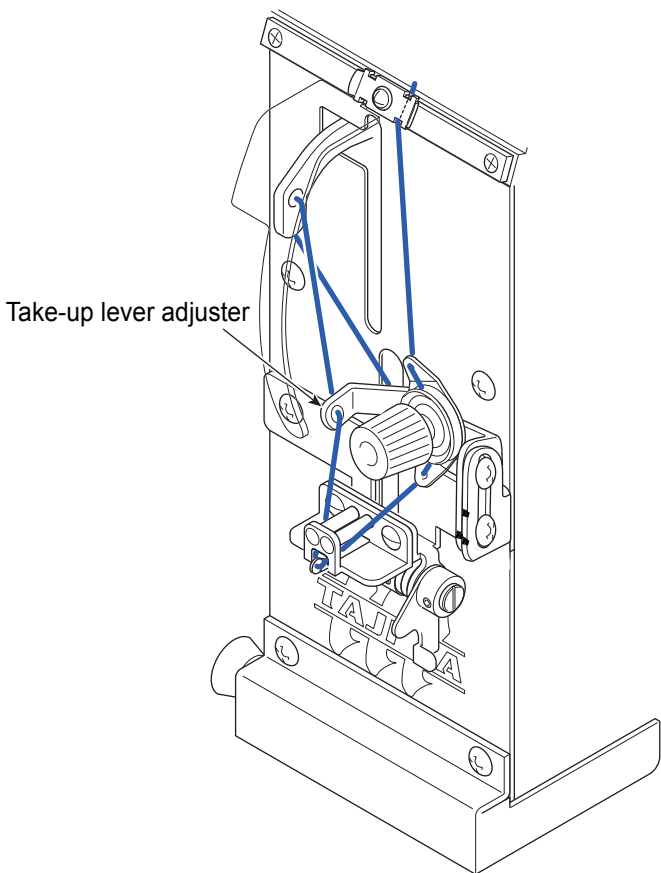
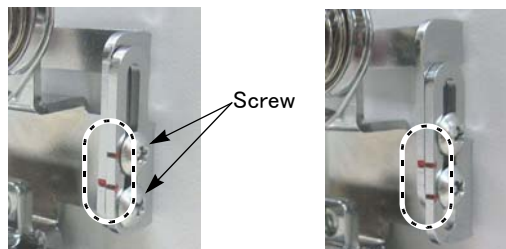

Figure A

Jumbo rotary hook

Regular rotary hook



Raising the take-up lever adjuster from the position shown the above figures will make the thread tension stronger furthermore.



2-2. To set the fabric to the embroidery frame

To make finishing of embroidery beautiful or to perform efficient works by reducing the thread breakage, it is important to stretch the fabric correctly on the embroidery frame. Fix fully stretched fabric without any line.

The number of clips and their length differ depending on the frame size. Attach the clips evenly by minimizing the interval between clips.

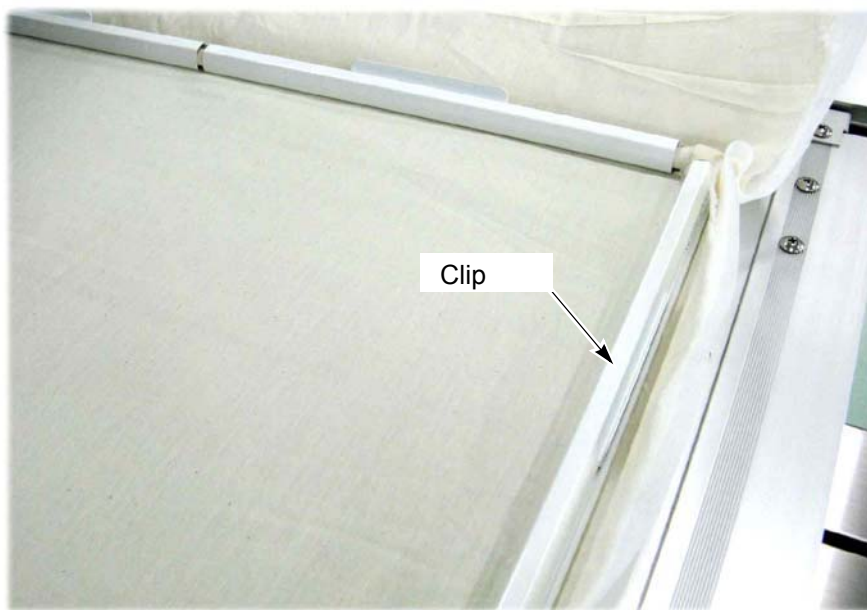

[How to fit in a clip]

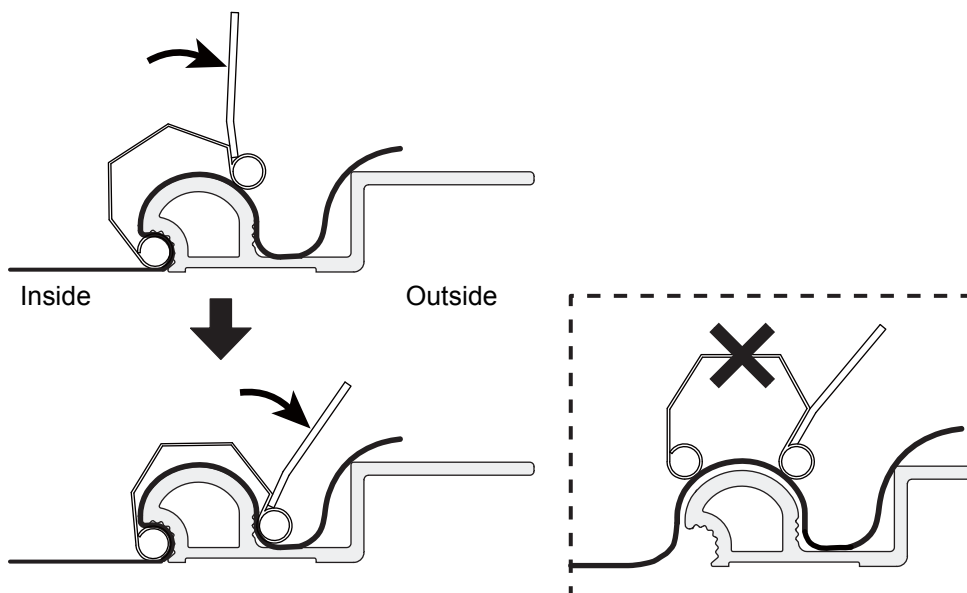

3. Registration of a design in the machine memory

Register a design in the machine memory by the following ways.

- (1) To use the USB memory
- (2) To use a personal computer (DG/ML by Pulse is necessary)

3-1. To use the USB memory (Data Input USB)

Register the designs saved in USB memory into the memory of the machine. The maximum number of stitches per one design is 1,000,000 stitches.

3-1-1. Explanation on the screen

[17-inch operation panel]

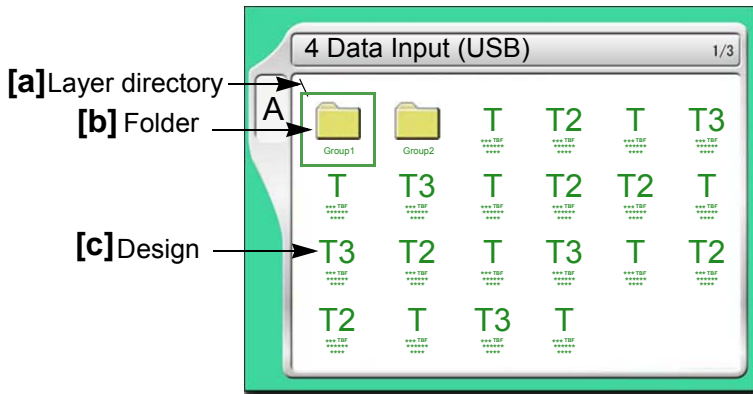

Folders and designs stored in the USB memory will be displayed. The design except the one shown at left will be displayed depending on a saving format of the design.

[6.5-inch operation panel]

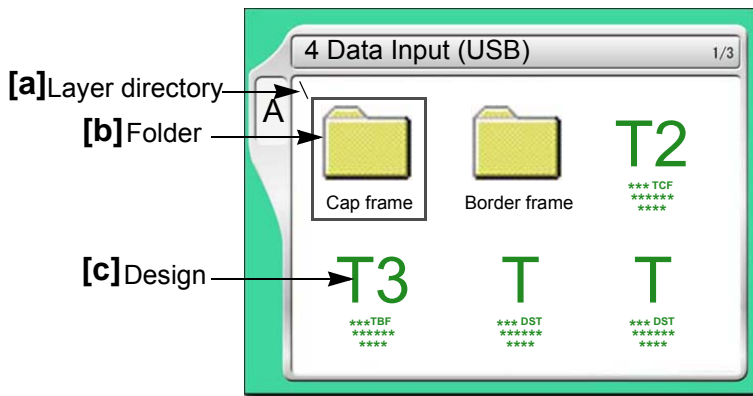

Folders and designs stored in the USB memory will be displayed. The design except the one shown at left will be displayed depending on a saving format of the design.

[a] Layer directory

The machine can read the design (down to the fourth layer directory) in the folder located at the third layer directory saved in the USB memory. The total amount of folders or designs which can be read in one layer directory is 255 designs at the maximum.

- \ : First layer directory
- \\ : Second layer directory
- \\\ : Third layer directory
- \\\\ : Fourth layer directory

[b] Folder

[c] Design

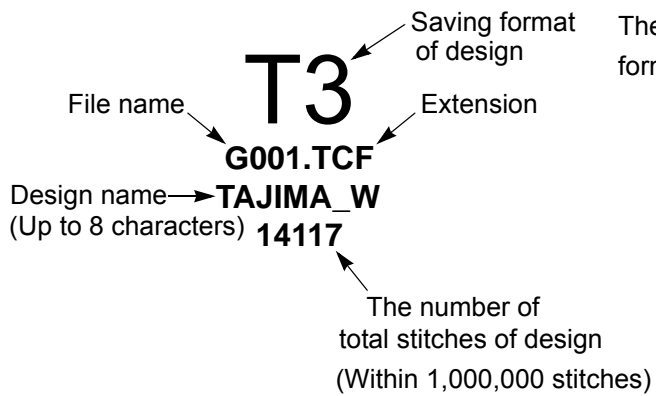

The extension differs depending on a saving format of the design.

- T3 : TCF
- T2 : TBF
- T : DST

3-1-2. How to operate

The following is an example when registering a design saved in a USB memory into the machine memory. After that, the explanation will be based on 17-inch operation panel for convenience.

(1) To set USB memory

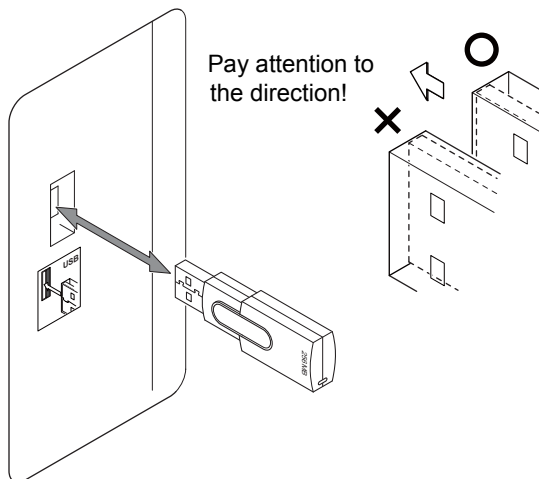

(2) To open screen

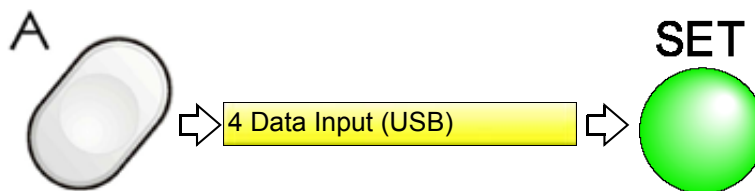

(3) To select a design

The operation differs depending on a storing place for the design.

(a) Design in a folder

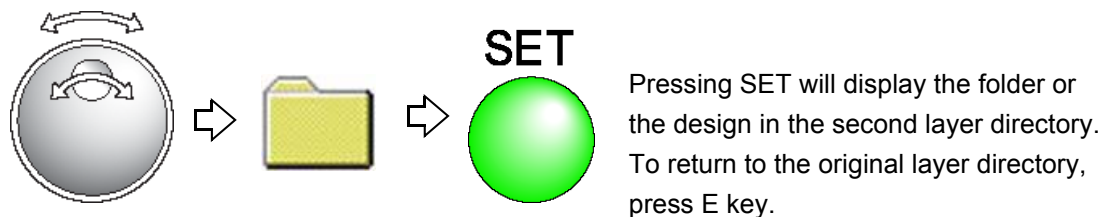

(b) Design on the screen

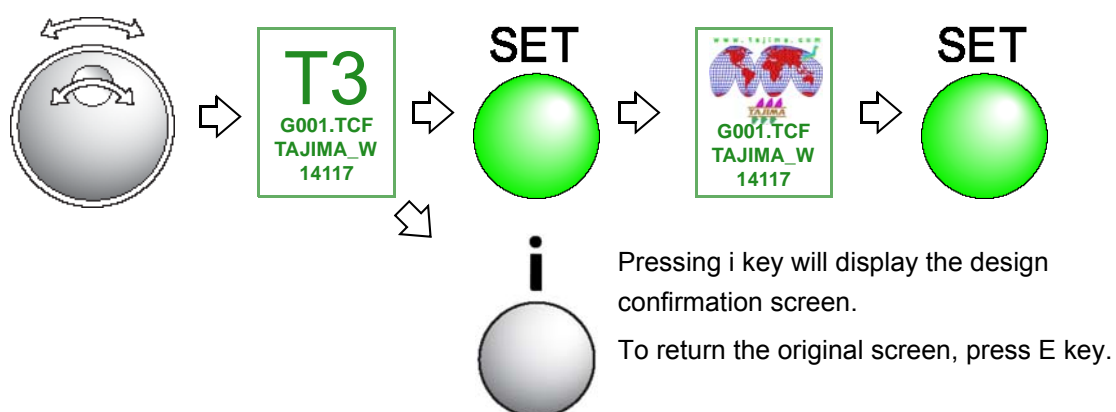

(4) Registration of a design in the memory of the machine

If a saving format of the design is T3 or T2, the following message will appear.

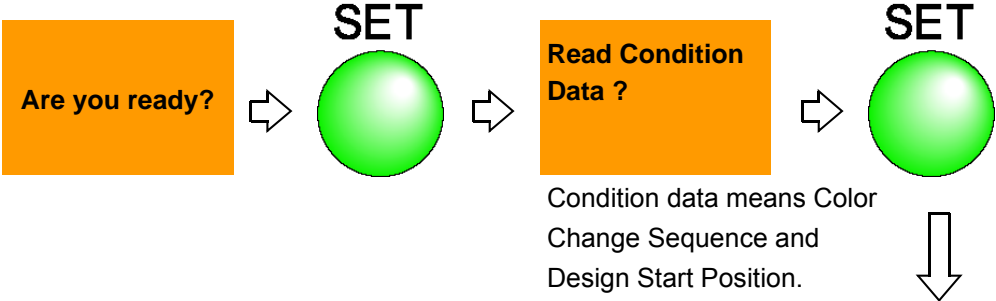

Condition data means Color Change Sequence and Design Start Position.

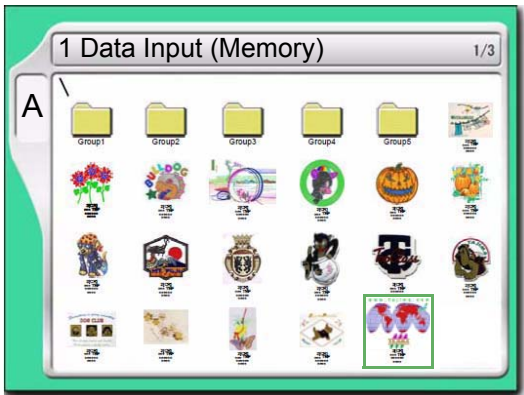

After that, proceed to "To decide an embroidery design (Data Setting) (→ p.18)".

3-2. To use a personal computer (Data Input Lan)

Register the design saved in a personal computer into the memory of the machine. The maximum number of stitches per one design is 800,000 stitches.

Software sold separately (DG/ML by Pulse) and setting of IP address is necessary to perform this operation. For details, please consult the distributor.

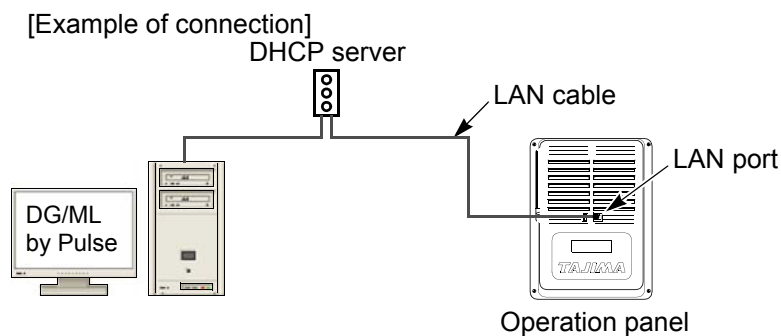

3-2-1. Explanation on the screen

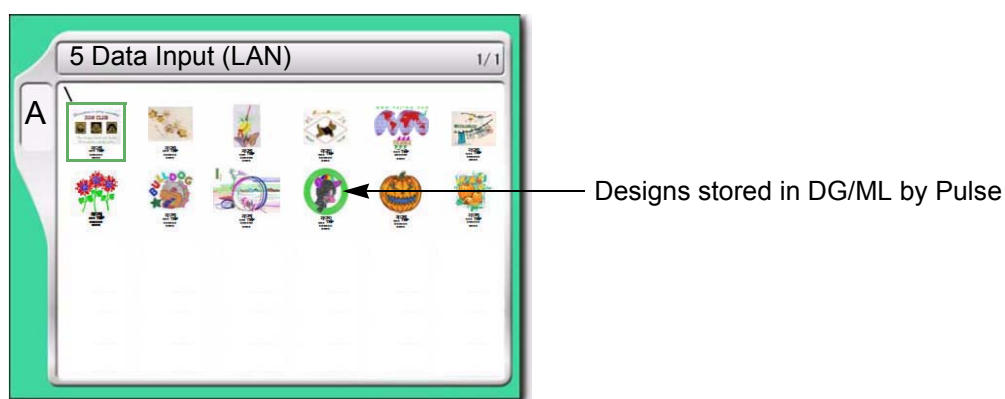

3-2-2. How to operate (not to use the bar code reader)

The following is an example when registering a design (stored in a personal computer) in the memory of the machine.

- (1) After connecting the LAN cable to the LAN port at the back of the operation panel, start up DG/ML by Pulse.
- (2) Check if network setting is "YES".
- (3) To open screen



(4) To select a design

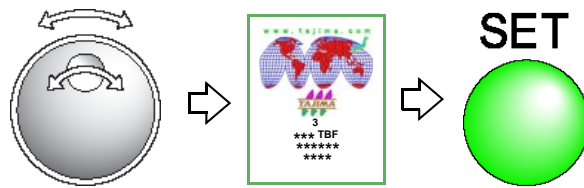

(5) Registration of a design in the memory of the machine

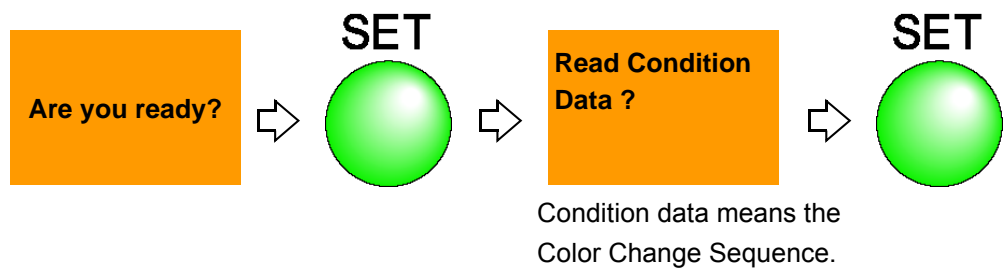

This design has become the state that it is possible to embroider (Data set is completed).

After that, proceed to "To change color automatically / to start operation automatically (Auto Color Change "AC" / Auto Start "AS") (→p.26)".

3-2-3. How to operate (to use bar code reader)

The following is an example when registering a design stored in a personal computer into the memory of the machine.

- (1) After connecting the LAN cable to the LAN port at the back of the operation panel, start up DG/ML by Pulse.
- (2) Check if network setting is "YES".
- (3) Connect the bar code reader to the USB port of the operation panel.

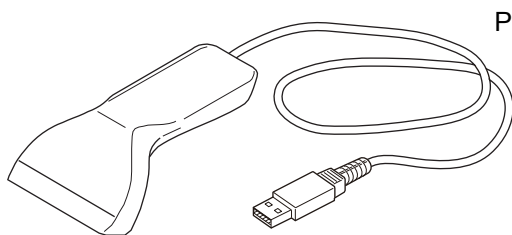

Please buy a commercial item.

- (4) Set the screen to the main screen.

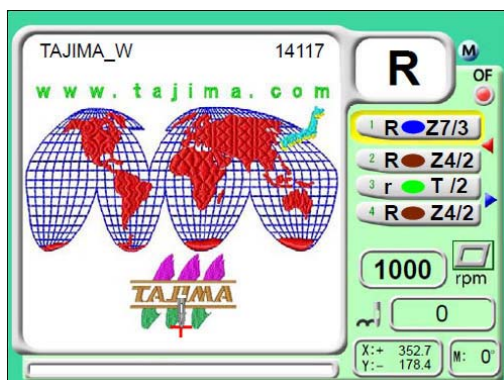

The bar code can be read from the following screen.

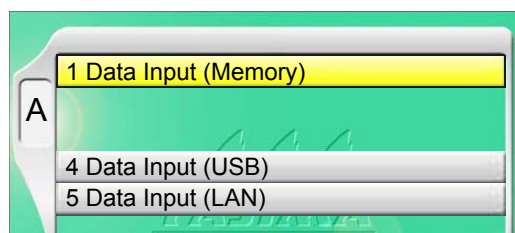

- (5) Read the bar code.

Condition data (Color Change Sequence) is also read automatically.

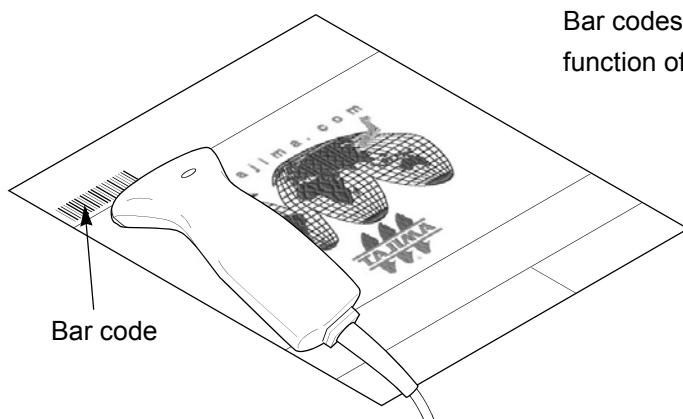

Bar codes can be printed by the print function of DG/ML by Pulse.

This design has become the state that it is possible to embroider (Data set is completed).

After that, proceed to "To change color automatically / to start operation automatically (Auto Color Change "AC" / Auto Start "AS") (→p.26)".

If the bar code cannot be read, error code No.BC1 will be displayed. The following points are given as factors.

(a) Selected design is not stored in Spooler

Spooler: Area to store the design temporarily in a personal computer

(b) Misreading by bar code reader

Deal with the following procedure. If the problem is not solved, please consult the distributor.

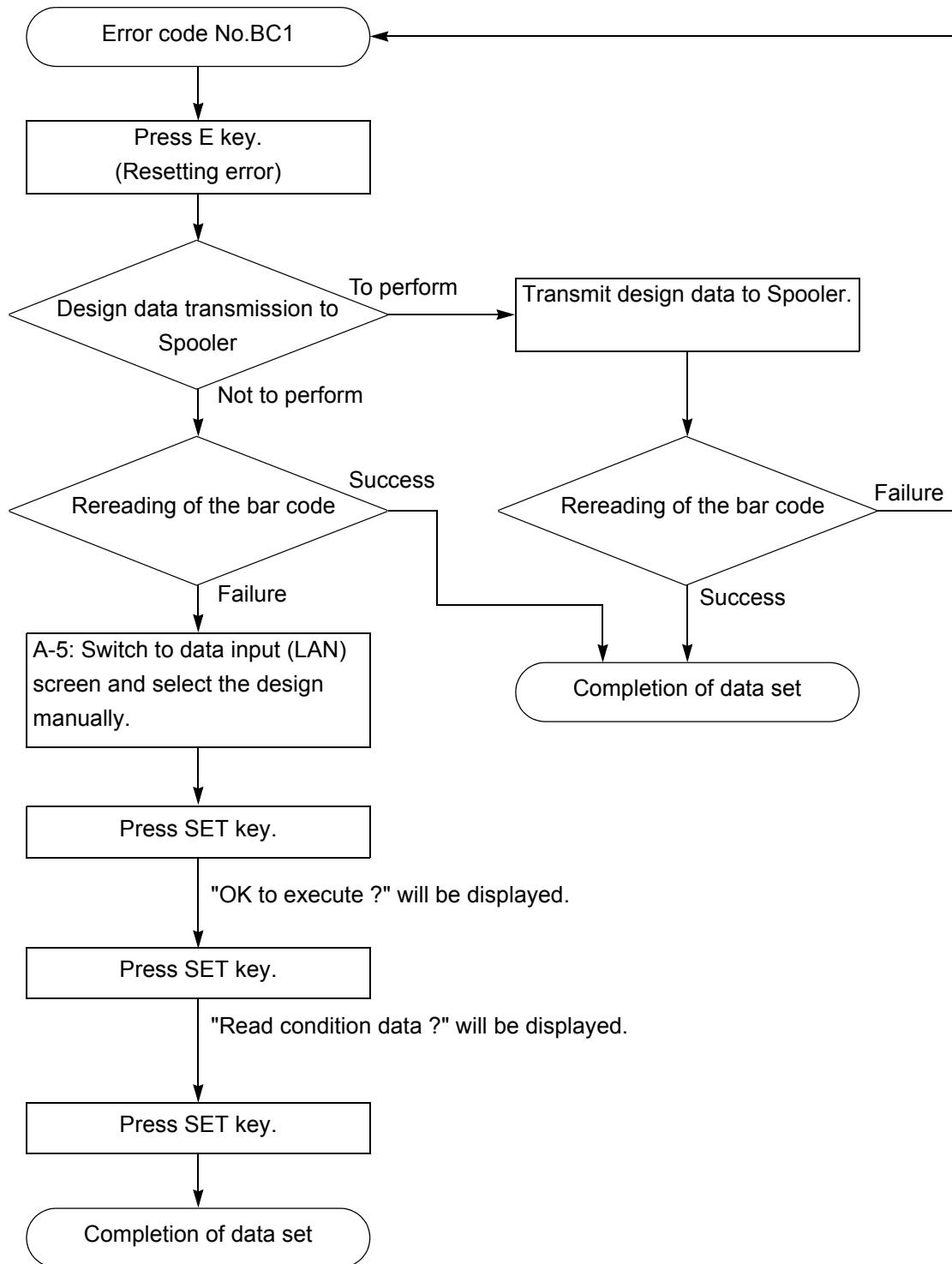

4. Decision of an embroidery design, Color Change Sequence

4-1. To decide an embroidery design (Data Setting)

Select the design in the memory of the machine and enable to embroider.

4-1-1. Explanation on the screen

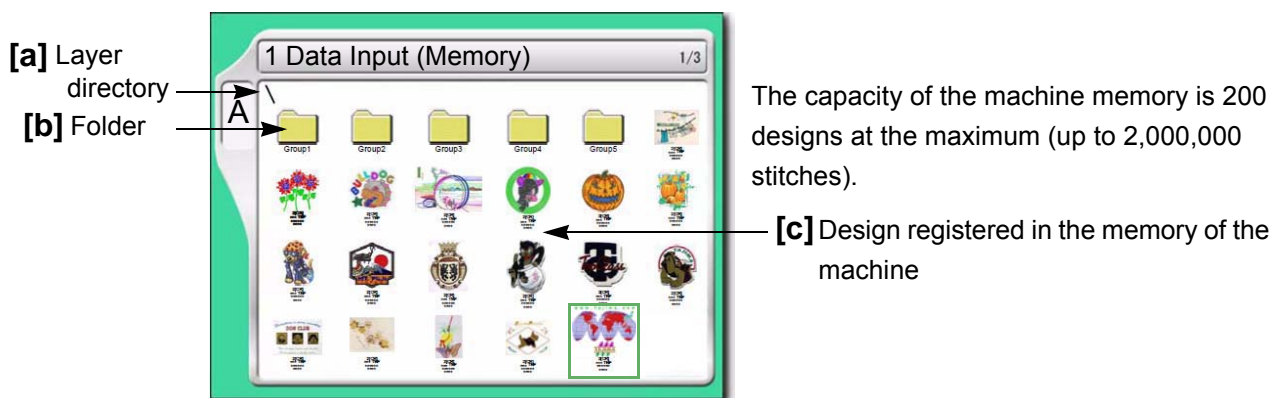

[a] Layer directory

The design stored in the memory of the machine can be displayed down to the second layer directory.

\ : First layer directory

\\ : Second layer directory

[b] Folder

Folder name can be changed.

[c] Design registered in the memory of the machine

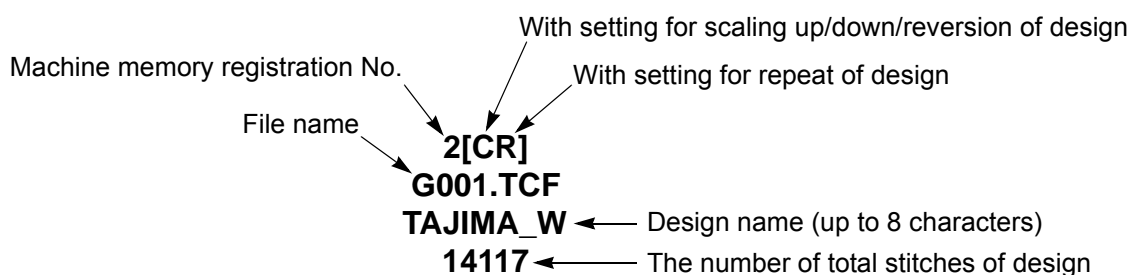

4-1-2. How to operate

This is an example when selecting the design in the memory of the machine and enabling to embroider.

(1) To open screen

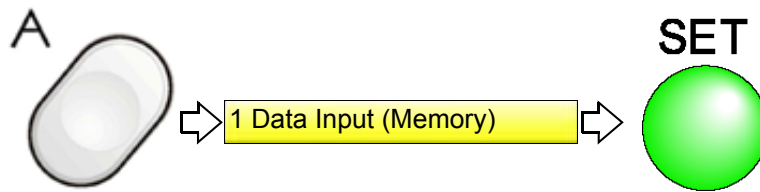

(2) To select a design

The operation differs depending on a storing place for the design.

(a) Design in a folder

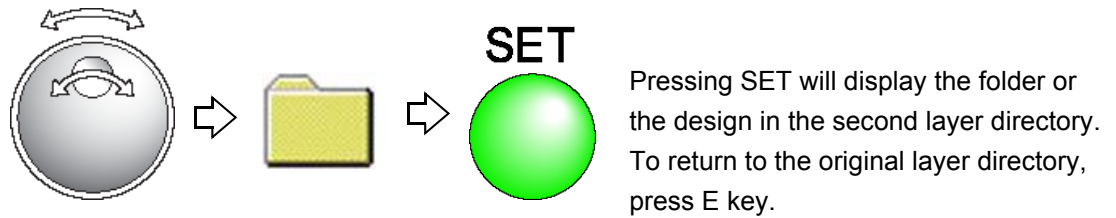

(b) Design on the screen

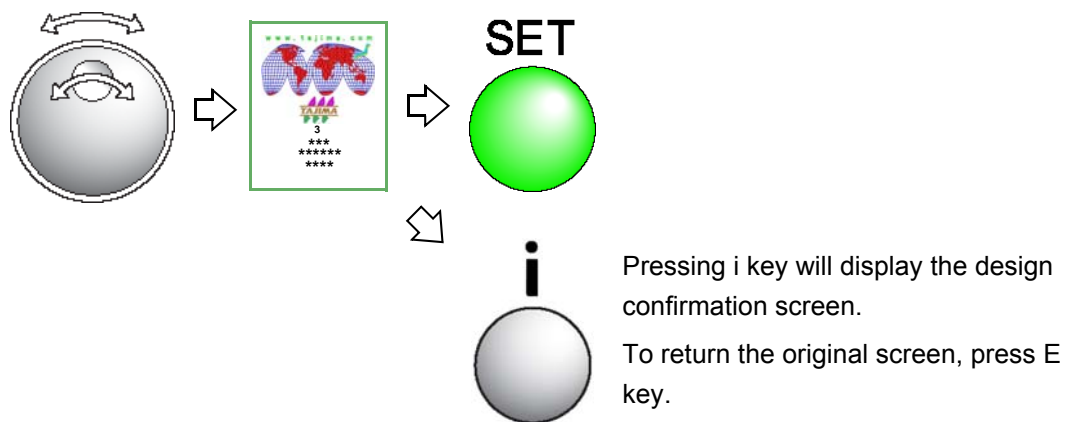

(3) To decide an embroidery design

! CAUTION

⊘ When performing this operation, do not put your hands etc. on the machine table. Moving the frame could injure you.

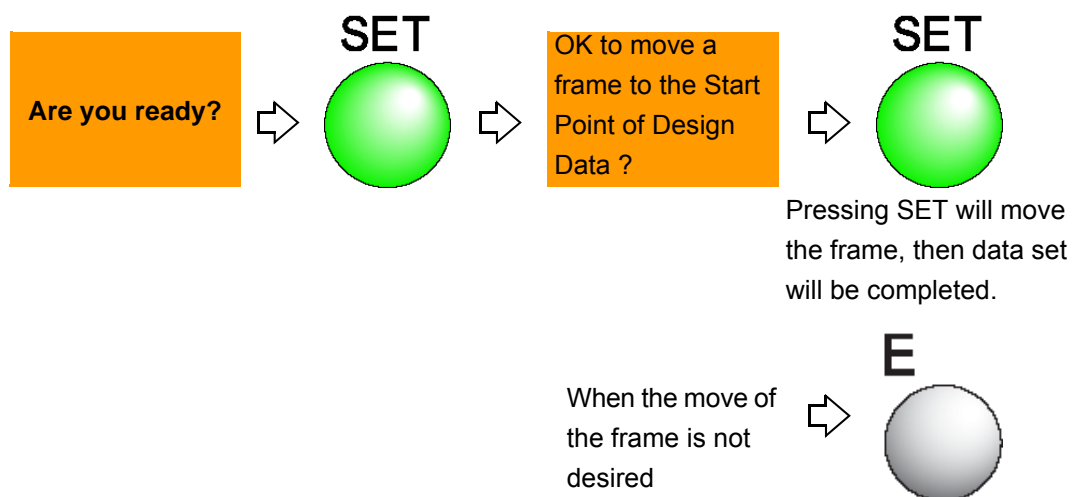

4-2. To decide order of embroidery type (Auto Stitch Type Selection)

This setting is unnecessary when the Color Change Sequence is already included as the condition data in the design to be embroidered from now.

4-2-1. Explanation on the screen

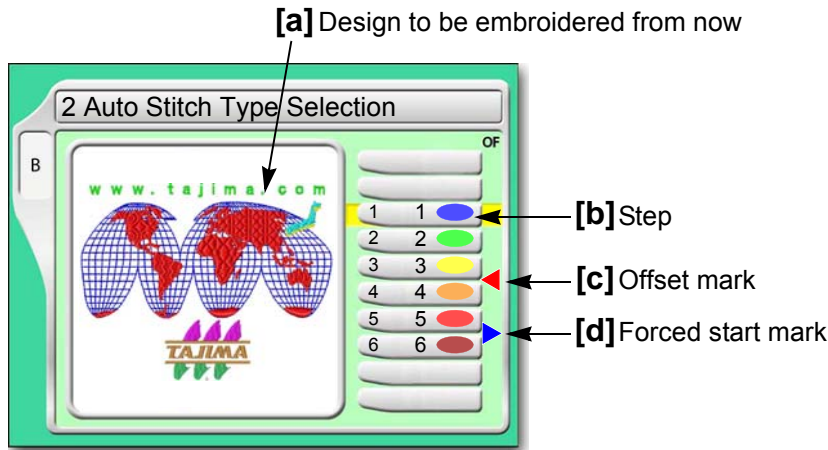

[a] Design (of which data is set) to be embroidered from now

[b] Step

The section divided by a color change code in the design data. The first section is called step 1, and the next section is called step 2.

[LM head]

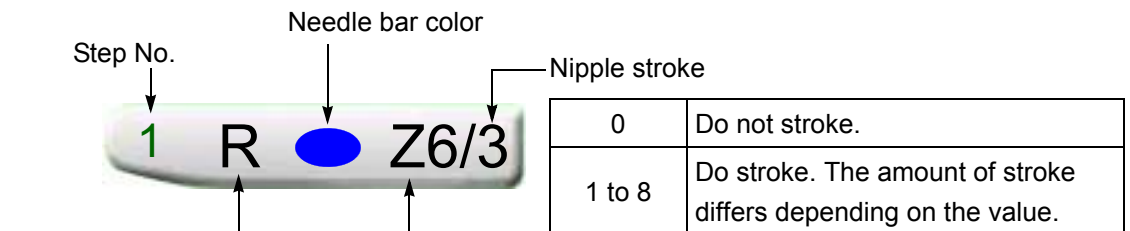

"R" means that the bobbin at standard side of LM head is selected.

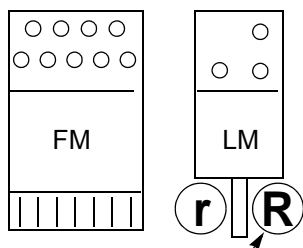

Bobbin at standard side

The above figure is an example of TLMX-mixed type.

N:Normal Embroidery

T: Taping

Z4: Zigzag swing embroidery

Z5: Zigzag swing embroidery

Z6: Zigzag swing embroidery

Z7: Zigzag swing embroidery

Z8: Zigzag swing embroidery

Z9: Zigzag swing embroidery

C: Coiling

H: Tuck embroidery

F: Frill embroidery

[FM head]

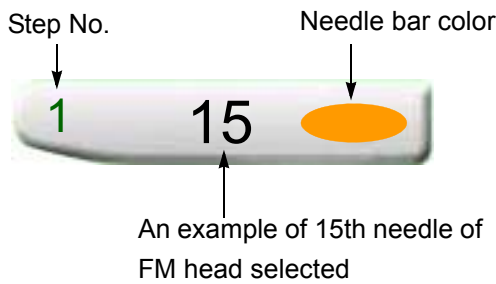

When Sequin device III is mounted, the following display appears.

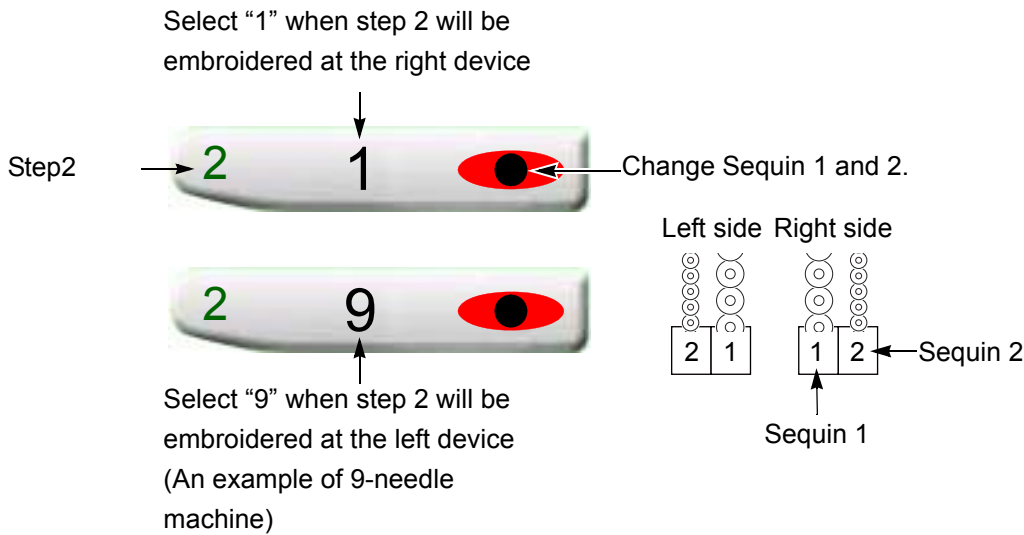

[c] Offset mark

The illustrated example shows that the frame moves to the front after finishing of step 3. However, to move the frame, the setting of "Automatic offset" is necessary.

[d] Forced start mark

"Auto start at same color" is performed even if the setting of "Auto start at same color" is "NO".

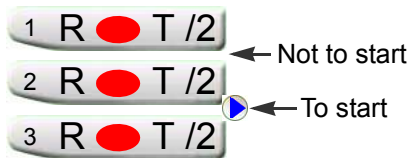

4-2-2. How to operate

The following is an example when embroidering step 2 in the conditions below.

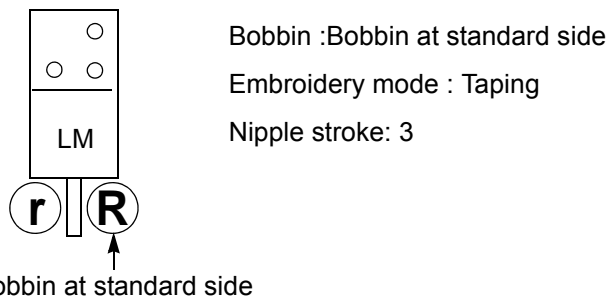

(1) To open screen

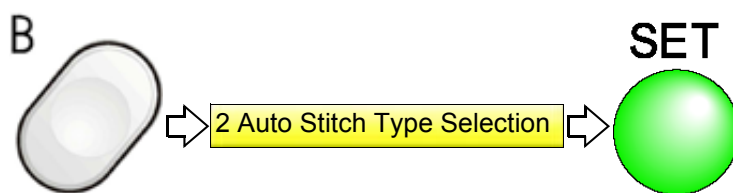

(2) To select Step 2

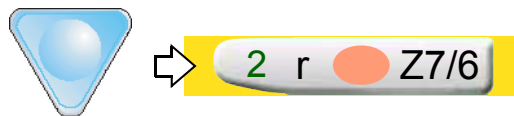

(3) To select bobbin (R) at standard side

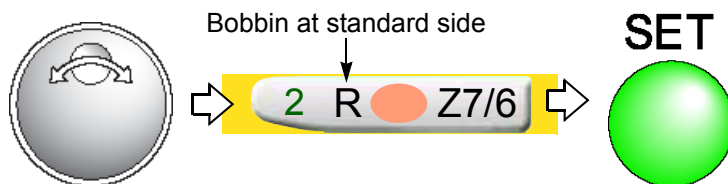

(4) To select the embroidery mode (Taping)

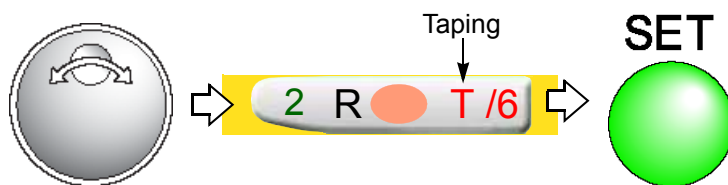

(5) To select nipple stroke 3

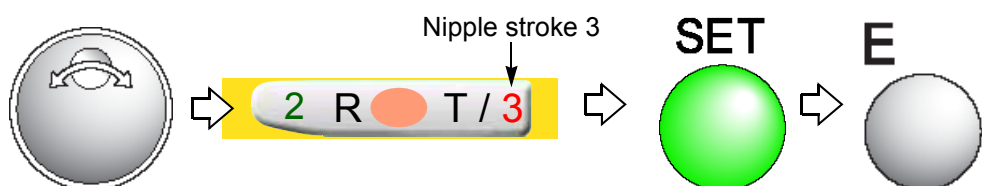

In case of TLMX mixed type, TLMX triple mixed type and TLMX-T00, the motion when starting the machine after that is as per the following.

(a) When it is in the middle of embroidery

When the current head is different from selected head at automatic stitch type selection, head will switch automatically after start of the machine and the frame will move.

(b) When it is not in the middle of embroidery

When the current head is different from selected head at automatic stitch type selection, head will switch automatically.

4-2-3. How to operate

The following is an example when setting step 1 to the needle bar No.4.

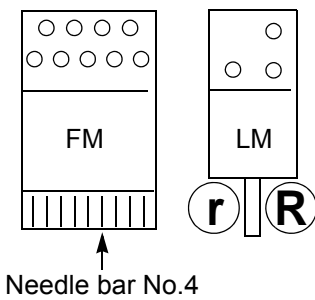

(1) To open screen



(2) To select the needle bar No. to use at the step 1



In case of TLMX mixed type, TLMX triple mixed type, TLMX-T00, the motion when starting the machine after that is as per the following.

(a) When it is in the middle of embroidery

When the current head is different from selected head at automatic stitch type selection, the head will switch automatically after start of the machine and the frame will move.

(b) When it is not in the middle of embroidery

When the current head is different from selected head at automatic stitch type selection, the head will switch automatically.

4-2-4. How to operate

The following is an example to insert the offset mark or the forced offset mark between step 2 and step 3.

(1) To select the step to insert the offset mark



(2) To insert the offset mark



(3) To delete the offset mark

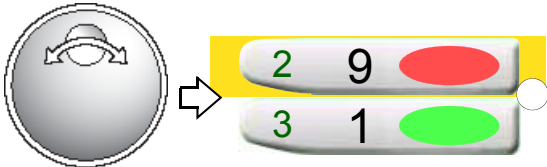

(4) To insert the forced offset mark

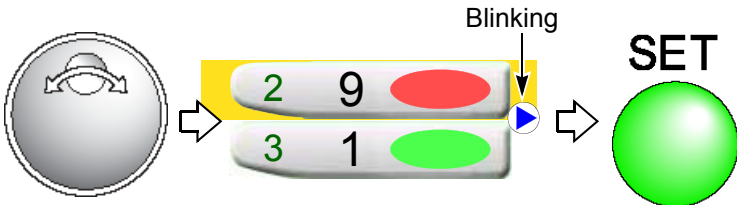

4-3. To change color automatically / to start operation automatically (Auto Color Change "AC" / Auto Start "AS")

4-3-1. Explanation on the screen

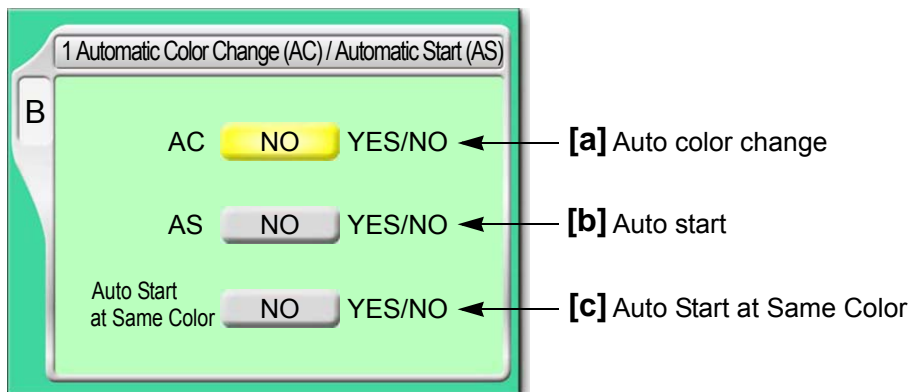

[a] Setting to perform color change automatically according to Auto Stitch Type Selection

YES: To perform

NO: Not to perform

Selecting NO will select the current needle bar or stitch type (LM head) irrespective of "Auto Stitch Type Selection".

In case of TLMX mixed type and TLMX triple mixed type, when [a] is changed from NO to YES in the middle of embroidery or when the head of "Auto Stitch Type Selection" is different from the current head, the frame will move to the neighbor head after start of the machine (fixed interval movement).

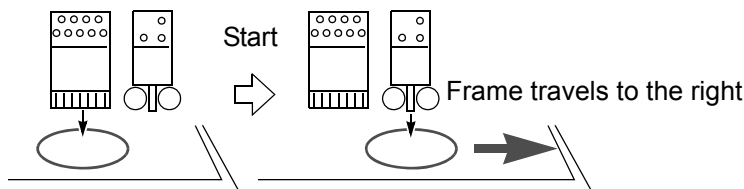

[b] Setting to start operation automatically after color change

YES: To perform

NO: Not to perform

Selecting "NO" will disable the following settings.

[c] Setting to start operation automatically when the same needle bar No. is selected at the previous and next steps.

YES: To perform

NO: Not to perform

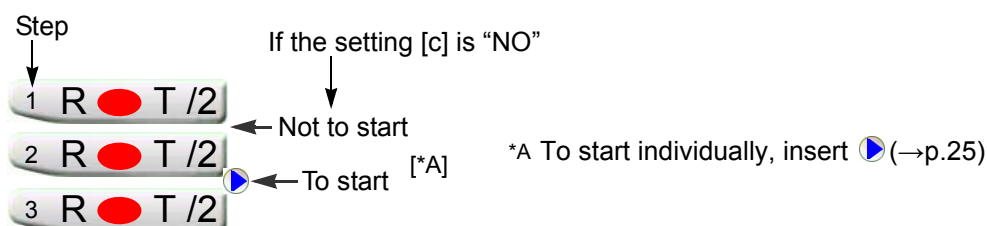

4-3-2. How to operate

The following example is for setting below three kinds of conditions.

Automatic Color Change (AC)

Automatic Start (AS)

Automatic Start at the same color

(1) To open screen

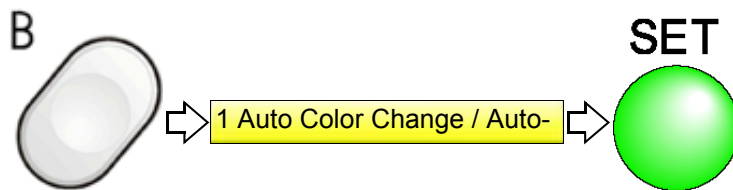

(2) Automatic Color Change (AC)



(3) Automatic Start (AS)



(4) Automatic Start at the same color



5. Decision of the design start position

5-1. To check the design size and the setting contents of the design (Check of design)

Check setting conditions such as size, scale up/down, repeat, etc of the design to be embroidered from now. Use the checking result as rough standard when deciding the design start position.

5-1-1. Explanation on the screen

The screenshot shows the software interface for checking design settings. On the left, a preview of the 'Tajima' logo design is shown. To its right, a settings panel displays the following information:

- Design ID: G0041 W-Tajima
- Stitch Count: 14117 st
- Current position (From Design Start Point): X: 0.0, Y: 0.0
- Stitch Counter: 0
- Stitch Length: X: -, Y: -
- Function: -
- Design Counter: 0
- Step: 1/8
- OFFSET:
- Bottom status bar: 3. 10. 5. 7. 2. 7. 8. 4.

Annotations on the right side of the interface indicate:

- Size of design (mm):** A vertical double-headed arrow indicates a height of 88.4 mm.
- Start position of design:** A horizontal double-headed arrow indicates a width of 118.8 mm, centered around a vertical line at X=0.0.

Labels on the left side of the interface point to specific settings:

- Design to be embroidered from now:** Points to the design preview.
- Scaling up/down/reversion of design:** Points to the 'Data conversion' section, which includes X: 80%, Y: 80%, and Rotation: 0°.
- Design repetition:** Points to the 'Repeat' section, which includes X: 3 / -130.0, Y: 3 / 100.0, and M. Repeat: pp.

The size based on the design start position after scaling up/down will be displayed. This example shows the size of vertical 88.4 mm and horizontal 118.8 mm.

5-1-2. How to operate

(1) To open screen

Press i key.



After pressing this key again, setting contents in detail and the code No. occurred up to now can be confirmed.

To return to the main screen, press E key.

5-2. To lower needle bar to adjust frame position (Needle bar operation) (FM head)

This function is applicable for TLMX-mixed type.

5-2-1. Explanation on the screen



5-2-2. How to operate



The following is an example of lowering the needle bar.

(1) To open screen

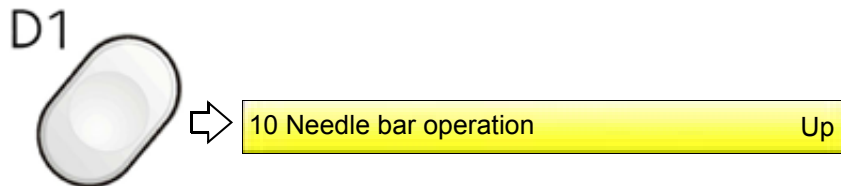

(2) To lower needle bar

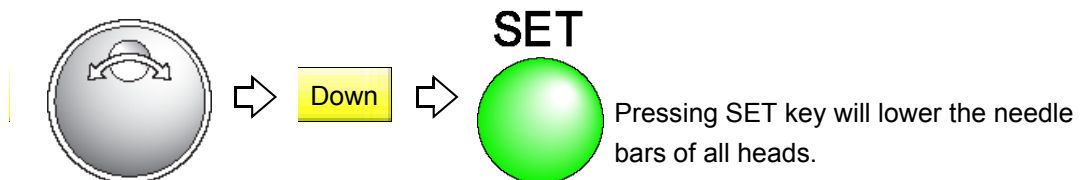

5-3. To move the frame to the design start position (Manual frame travel)

This operation is unnecessary when the frame has already come to the start point of the design by the operation described previously.

5-3-1. Explanation on the screen

Main screen

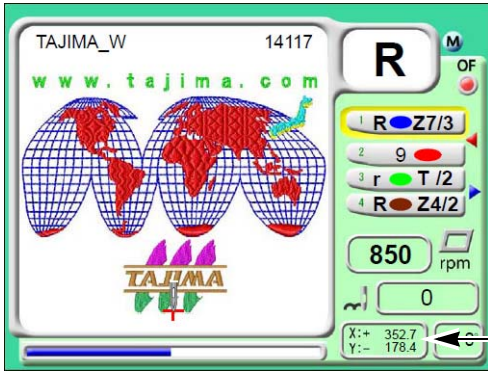

The current frame position is displayed by the numerical value (mm). The frame position is based on the Frame Origin.

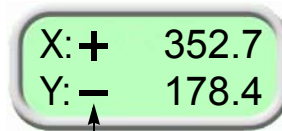

The code (+/-) means the frame travel direction.

[Relation between frame travel direction and code]

- (1) If the frame moves to the rear, the mark will be "Y:-".
- (2) If the frame moves to the front, the mark will be "Y:+".
- (3) If the frame moves to the right, the mark will be "X:-".
- (4) If the frame moves to the left, the mark will be "X:+".

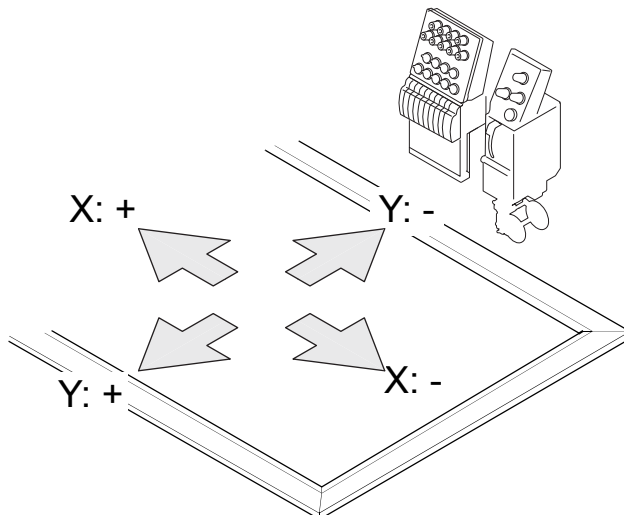

5-3-2. How to operate

There are three methods of operation as described below.

 **CAUTION**

 When performing this operation, do not put your hands etc. on the machine table. Moving the frame could injure you.

(1) To use frame travel key

(a) Switch to main screen

Press E key plural times to switch to the main screen.

(b) To move the frame to design start position

Press any desired key. The frame will move.

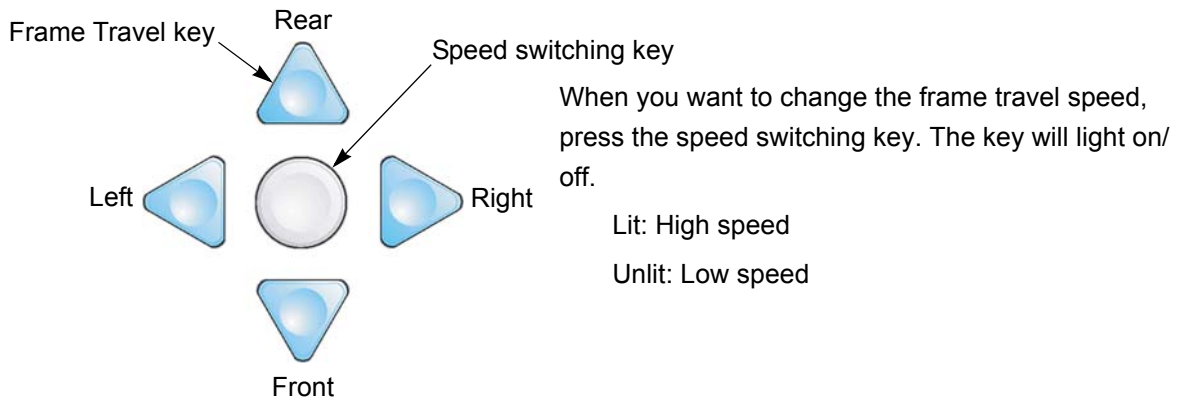

(2) To use Jog dial /Jog shuttle

(a) Switch to main screen

Press E key plural times to switch to the main screen.

(b) To decide the frame travel direction

Press E key to decide the frame travel direction.

It moves vertically.

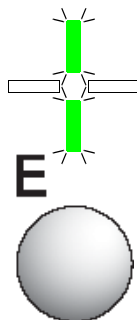

It moves horizontal.

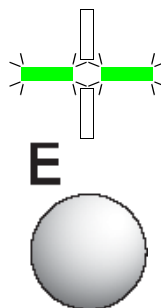

(c) To move the frame to design start position

Turn the jog dial (low speed) / the jog shuttle (high speed). The frame will move.

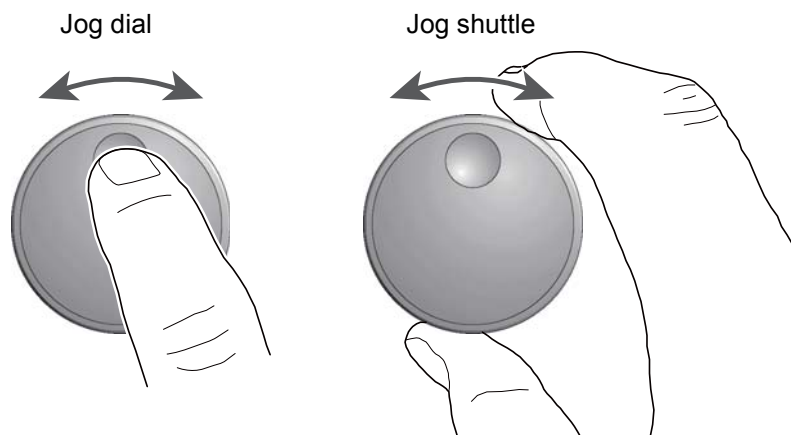

(3) To use Jog remote-controller (Option)

(a) Switch to main screen

Press E key plural times to switch to the main screen.

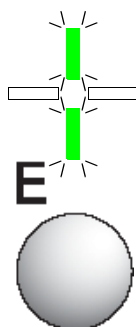

(b) To move the frame to design start position

Tilt the stick. The frame will move.

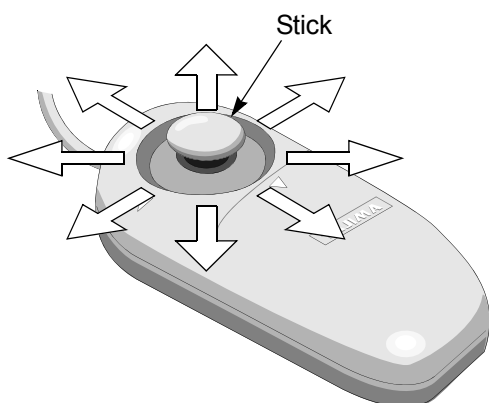

Frame travel speed will be changed by degree of leaning condition of the stick.

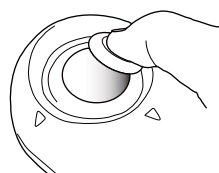

5-4. To check if a design fits in an embroidery space (Trace)

Since the frame moves according to the size of the frame, you can check whether the design fits in the embroidery space or not.

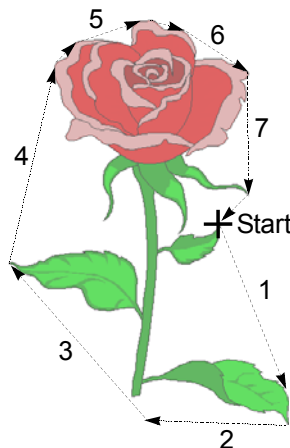

The number in the left picture indicates the orbit of the frame. After completion of trace, embroidering from that position is possible.

When repeat is set

The machine will trace the whole designs after tracing the first design.

When automatic offset is set

The machine traces according to setting.

5-4-1. Explanation on the screen

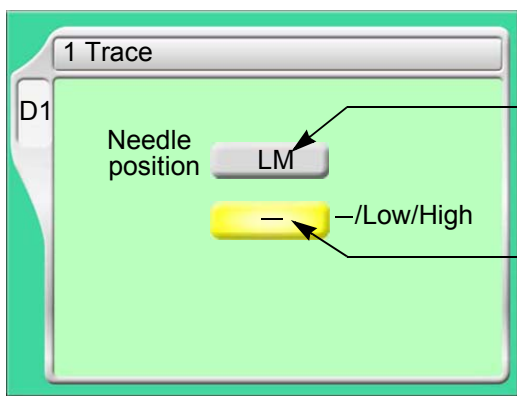

The frame will move on the basis of the current needle No. or LM head.

Speed of frame travel

Low: Low speed

High: High speed

-: Not to execute

5-4-2. How to operate

CAUTION

When performing this operation, do not put your hands etc. on the machine table. Moving the frame could injure you.

The following is an example when executing trace.

(1) To open screen

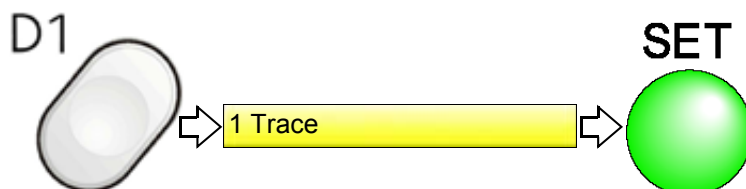

(2) To execute



When the tracing is impossible due to the design size exceeding the embroidery space, follow the procedure below after checking the size of the design.

- (a)** The frame will move again after temporary stop.
- (b)** Code No.225 will be displayed.
Press E key.
- (c)** Move the frame to the design start position.
- (d)** Perform tracing again.

To interrupt trace, follow the procedure below.

- (a)** Suspend the operation by the bar switch or the stop switch.
Code No.1C1 will be displayed.
Do not turn OFF while code No. 1C1 is displayed.
- (b)** Press E key.
- (c)** After that, follow the message described below.

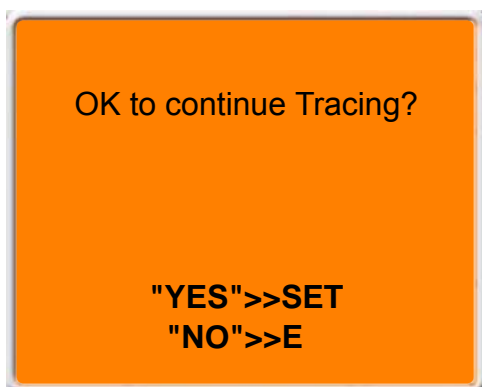

To continue → SET key
To suspend →E key

6. Check items before embroidering

6-1. Maximum speed (Max revolution)

The value set here will be the maximum speed of the machine. It is automatically increased/decreased depending on stitch length in the middle of embroidery.

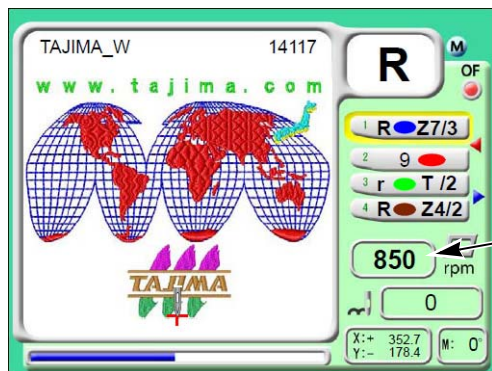

Speed display column
 During stop: The maximum speed is displayed.
 During operation: Actual operating speed is displayed.

Stitch Length	Embroidery speed
Up to 4.0 mm	Maximum speed (A in the right figure)
4.1 mm to 11.9 mm	Automatic change (B in the right figure)
12.0 mm or more	Low speed (C in the right figure)

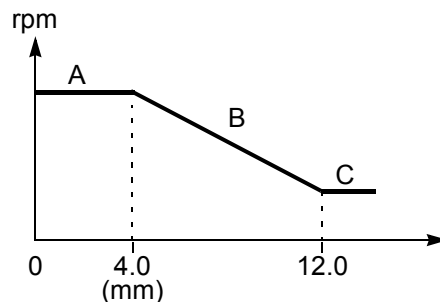

6-1-1. Explanation on the screen

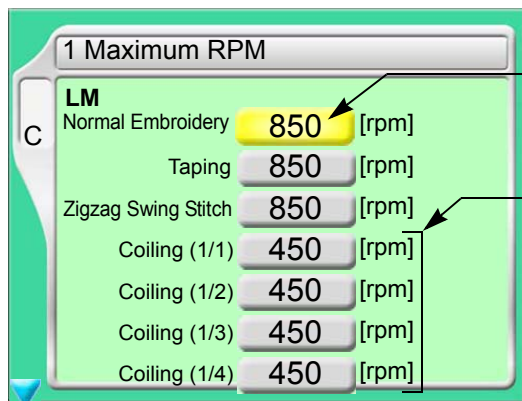

Maximum RPM of LM head

Coiling

When setting "Coiling" to 500 rpm in "Max. Revolution Limit", it is possible to increase speed of coiling (1/*) up to the following rpm.

1/2 : 750 rpm

1/3, 1/4 : 1000 rpm

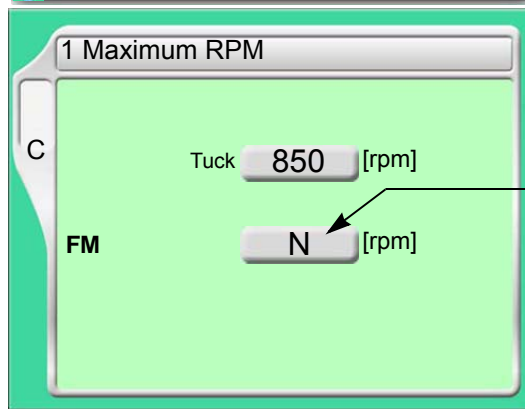

Maximum RPM of FM head

When "N" is displayed, maximum RPM differs per needle bar.

To apply the same RPM to all needle bars, change "N" to a value. When a value is displayed, the same RPM is applied to all needle bars.

6-1-2. How to operate

The following example is for setting the maximum RPM of LM head to "950".

(1) To open screen

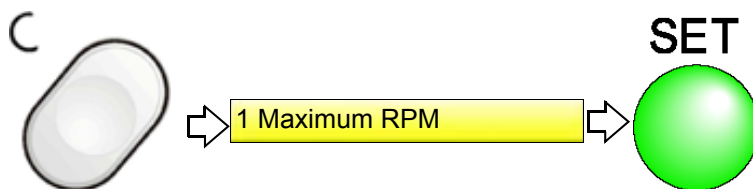

(2) Select maximum speed

Selection of the value exceeding "Max. Revolution Limit" is not possible.

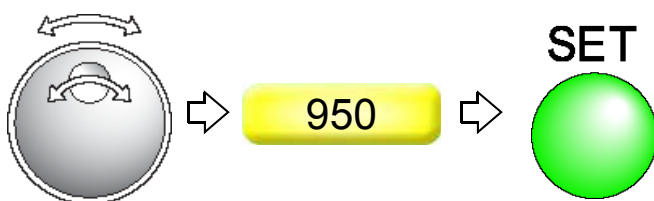

To change the maximum speed during operation of the machine, turn the jog dial / the jog shuttle.



While turning the jog dial, the following display appears.

The number described in [] is the maximum speed.

[850]

6-2. Embroidery head

6-2-1. FM head

Check the position of the following tension base switch, needle bar suspension lever before embroidering. Regarding the tension base switch and the needle bar suspension lever, embroidering is possible only when both of them are set to "ON".

(1) Tension base switch

This switch will suspend the head electrically.

The switch manipulation during operation of the machine is invalid. Even if the switch manipulation is executed, it will become effective after the machine stops.

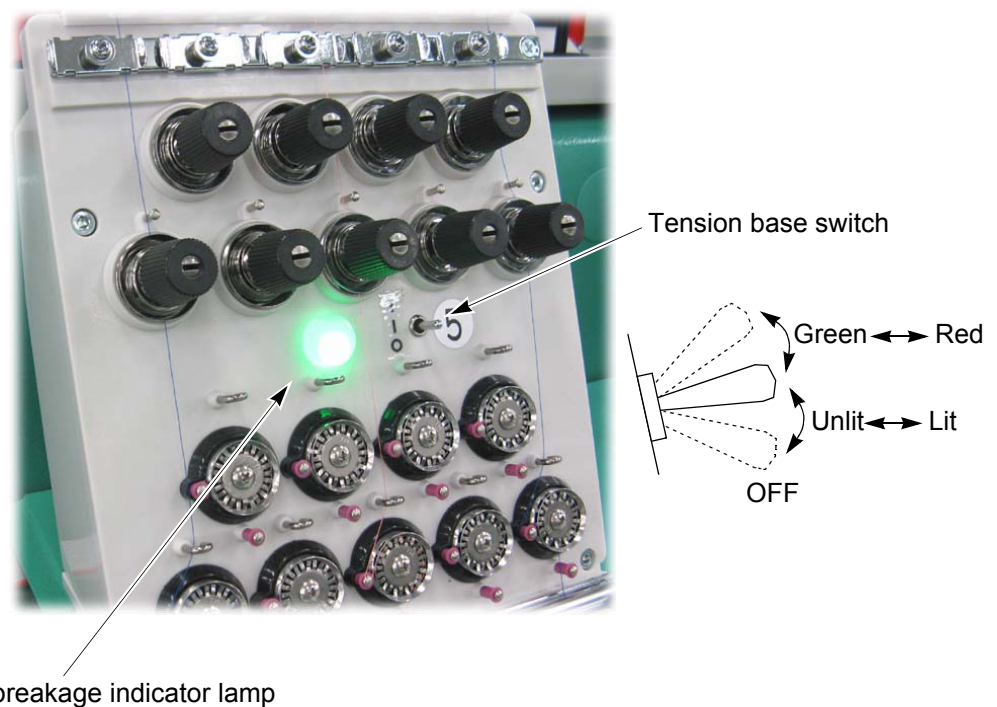

Thread breakage indicator lamp

Lit in green	Embroidery is possible. When FM head is selected
Unlit	Embroidery is suspended. (Needle bar will not move down.) When LM head is selected
Blinking in green	Frame back section at the head without thread breakage. The lamp at the head without thread breakage blinks in green during frame back. Regarding frame back, refer to the detail page.(→p.42)
Lit in red	Upper thread breakage
Blinking in red	Under thread breakage

(2) Needle bar suspension lever

This lever will suspend the head mechanically.

It is located at the left side of the head.

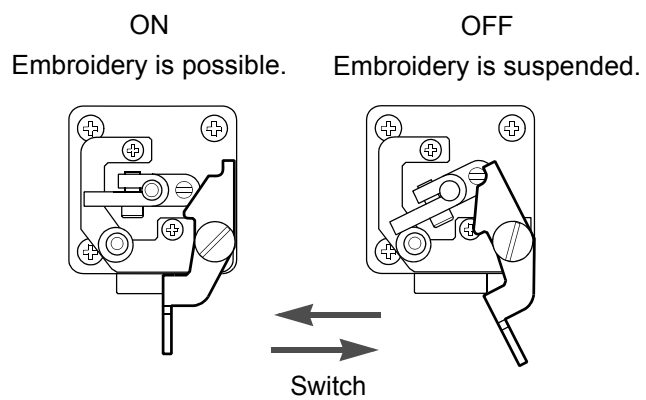

6-2-2. LM head

Check the position of the following tension base switch before embroidering.

It is possible to perform embroidery only when the tension base switch is set to "ON". This switch will suspend the head electrically.

If the switch is turned "OFF", the nipple will move up and the bobbin will return to the retracting position.

The switch manipulation during operation of the machine is invalid. Even if the switch manipulation is performed, it will become effective after the machine stops.

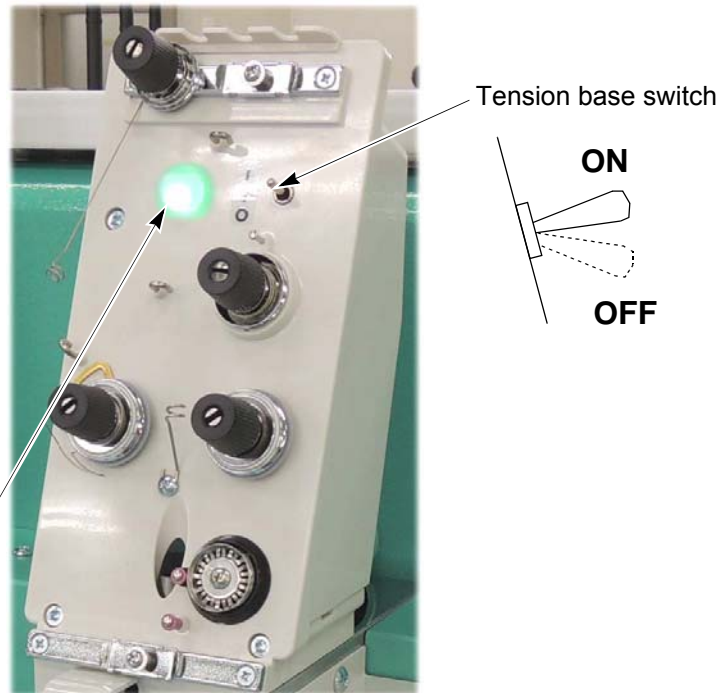

Thread breakage indicator lamp

Lit in green	Embroidery is possible. When LM head is selected
Unlit	Embroidery is suspended. (Needle bar will not move down.) When FM head is selected The nipple will move up and the bobbin will return to the retractable position.
Blinking in green	Frame back section at the head without thread breakage. The lamp at the head without thread breakage blinks in green during frame back. Regarding frame back, refer to the detail page.(→p.42)
Lit in red	Upper thread breakage
Blinking in red	Under thread breakage
Blinking in red and green	When the drive of the bobbin and the nipple is released

6-2-3. Attachment

Attach attachments (guide, bobbin bracket) according to stitch type (embroidery method).

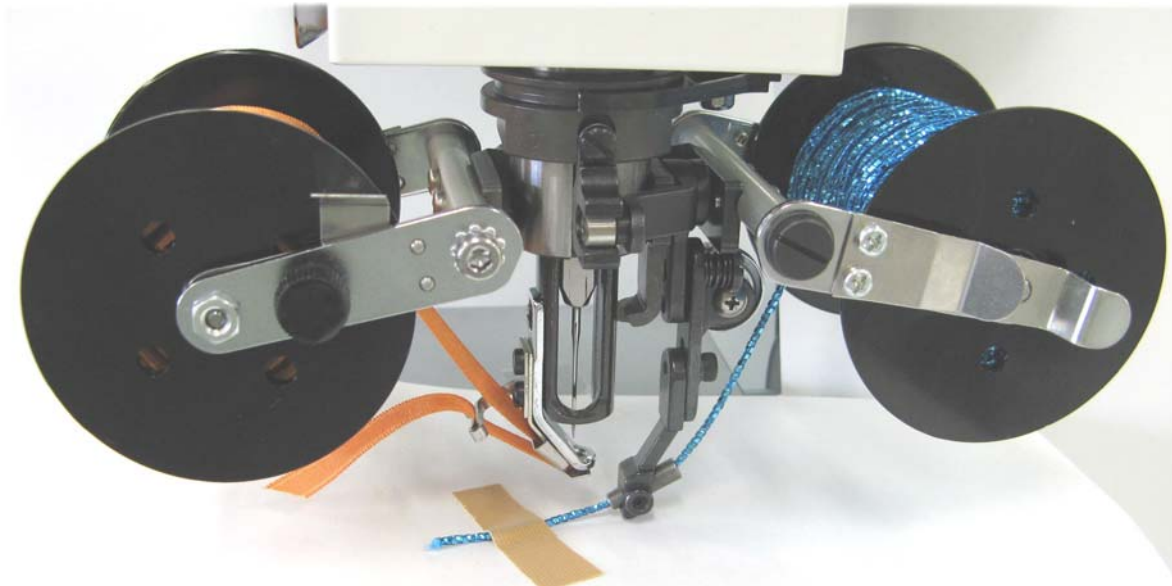

Fix the end of material by using tape so that sewing of the material becomes stable. After start of the machine, stop the machine once and cut the end of the material.

7. Embroidery starts

7-1. Start and stop

⚠ CAUTION

ⓘ Before starting the machine, pay enough attention to the surrounding safety. Moving needle bar and/or frame could injure you.

7-1-1. Bar switch

- (1) When starting the operation, move the bar switch to the right.
- (2) To stop the machine, move the bar switch to the left.
- (3) To start slow operation, move it to the right and keep at that position. Returning to the original position will start normal operation.



7-1-2. Start/stop switch

This switch is equipped in some models.

- (1) When starting the operation, press the start switch.
- (2) To stop the machine, press the stop switch.
- (3) To start slow operation, keep on pressing the start switch. Releasing it will start normal operation.



7-2. Frame Back (to return the frame) / Frame Forward (to advance the frame)

Frame Back

This function will return the frame to the direction where stitches return with the needle bar stopped.

Frame Back is performed when thread breaks, and the repair stitches are performed from that position only at the head with thread breakage.

Frame Forward

This function will move the frame to the direction where stitches advance with the needle bar stopped.

The frame can be moved immediately to the embroidery start point when you want to start from the middle of embroidery.

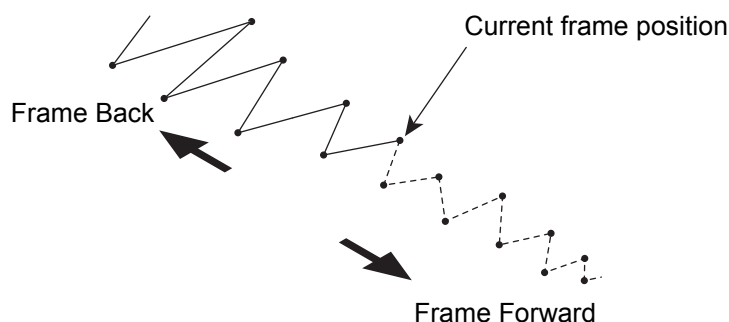

There are following two types of execution of Frame Back/Forward.

(1) Operation by operation panel

The machine will execute FB/FF by color change unit or by specifying the number of stitches.

(2) Operation by bar switch or stop switch

The machine will execute FB/FF by 1-stitch or setting unit. (Explanation is given as follows.)

[Current setting condition]

You can check which of Frame Back or Frame Forward is selected by the operation panel.

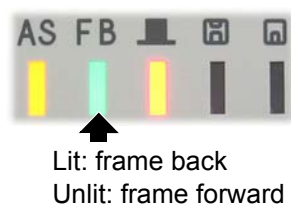

If the machine detects thread breakage, Frame Back will be set temporarily.

7-2-1. Frame Back/Forward by bar switch

 CAUTION	
<p> When performing this operation, do not put your hands etc. on the machine table. Moving the frame could injure you.</p>	

<p>Move the bar switch to the left and return to the original position immediately during stop.</p>	<p>Frame Back or Frame Forward will be performed by 1-stitch unit depending on the current setting condition.</p>
<p>Move the bar switch to the left and keep at that position during stop.</p>	<p>The machine will continue FB/FF by 1-stitch unit in case within 10 stitches. Returning to the original position will suspend FB/FF.</p> <p>The machine will continue FB/FF by setting unit in case of 11 stitches or more. [*1]</p> <p>Returning to the original position will not suspend the machine operation. When suspending, move it to the left.</p>

*1: Change of Frame feed unit

FM head: It is possible to select among 1, 3 and 5 stitches.

LM head: 1-stitch unit

7-2-2. Frame Back/Forward by stop switch

⚠ CAUTION	
<p>⊘ When performing this operation, do not put your hands etc. on the machine table. Moving the frame could injure you.</p>	

Press the stop switch and release immediately during stop.	Frame Back or Frame Forward will be performed by 1-stitch unit depending on the current setting condition.
Keep on pressing the stop switch during stop.	The machine will continue FB/FF by 1-stitch unit in case within 10 stitches. Releasing it will suspend FB/FF.
	The machine will continue FB/FF by setting unit in case of 11 stitches or more. [*1] Releasing it will not suspend the machine operation. When suspending, press the stop switch again.

*1: Change of Frame feed unit

FM head: It is possible to select among 1, 3 and 5 stitches.

LM head: 1-stitch unit

7-3. Countermeasure against thread breakage

The machine will stop automatically and will be in the following condition.

(1) The thread breakage indicator lamp lights in red or blinks in green.

Lit in red: Upper thread is broken.

Blinking in red: Under thread is broken.

Thread breakage indicator lamp

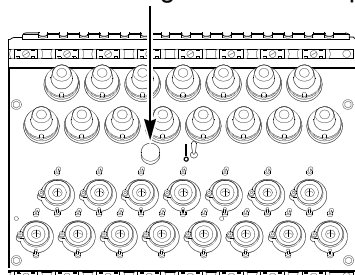

Thread breakage indicator lamp

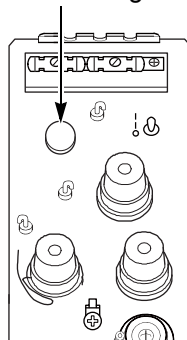

(2) Code No. (number indicating stop factor) will be displayed on the operation panel.

[291]: Upper thread is broken

[293]: Under thread is broken

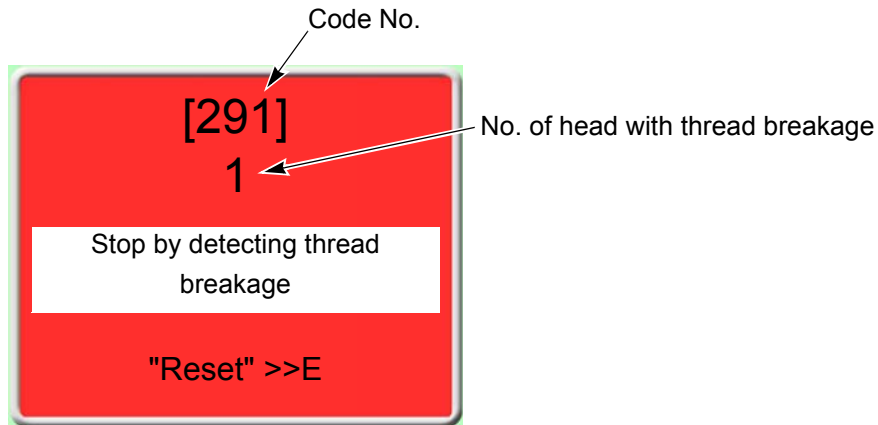

After that, restart the embroidery according to the following procedure.

(a) Pass the upper thread, or change the under thread (bobbin).

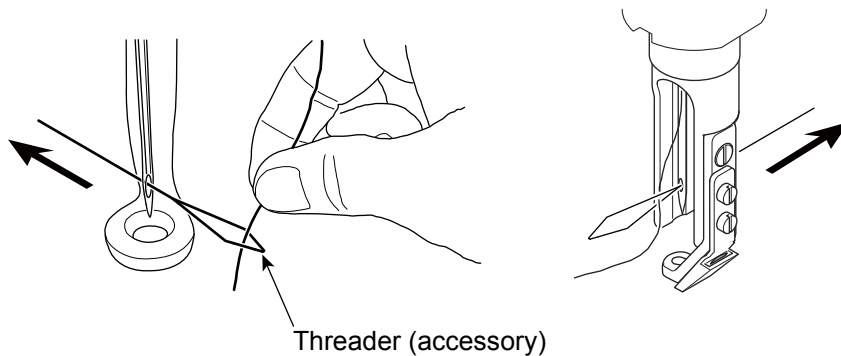

(b) Start the operation after performing Frame Back by several stitches.

Starting stitches after frame back differ between the head with thread breakage and the head without thread breakage.

[Head with thread breakage]

The machine restarts embroidery from the position where Frame Back stopped (1 in the figure below). As a result, repair stitches will be performed at the position 2 with missing stitches due to thread breakage.

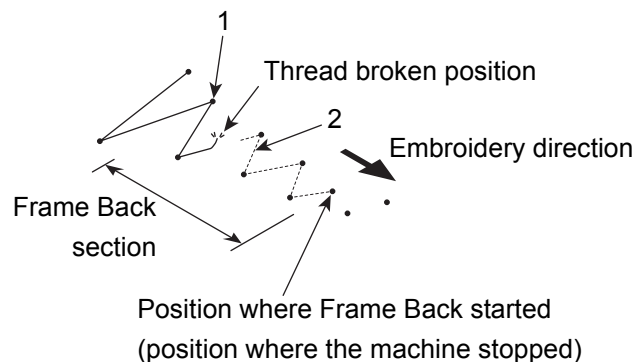

[Head without thread breakage]

The machine restarts embroidery from the position 3 next to where frame back started. This example is for the case "All head sewing after frame back" is set as "0".

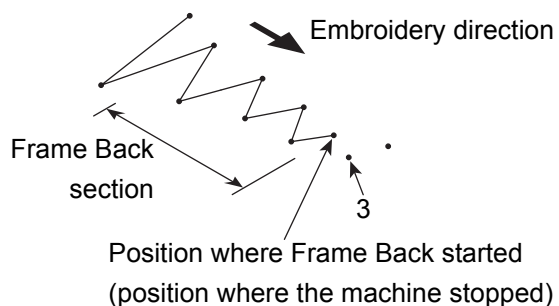

To make the head without thread breakage embroider from the position where frame back is stopped, set the tension base switch of the head to the "Top" once (when you release the switch, it will return to the original position). However, if "M-axis retraction for frame back" is set to YES in LM head, set the tension base switch of the head to the "Top" once before the start of frame back so that the embroidery in the head without thread breakage can be performed from the position where frame back is stopped.

Tension base switch

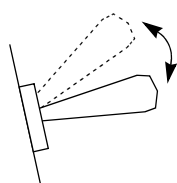

Thread breakage indicator lamp is change from green to red.

7-4. Completion of embroidery

Procedure after the completion of embroidery differs depending on head (FM head or LM head) selected at the last step.

(1) If FM head is selected

The frame will move according to the setting of automatic offset.

(2) If LM head is selected

The machine will stop.

(a) Cut the material and upper thread by using scissors etc.

(b) When starting the machine, the frame will move according to the setting of automatic offset. (Refer to Fig 1.)

Fig. 1

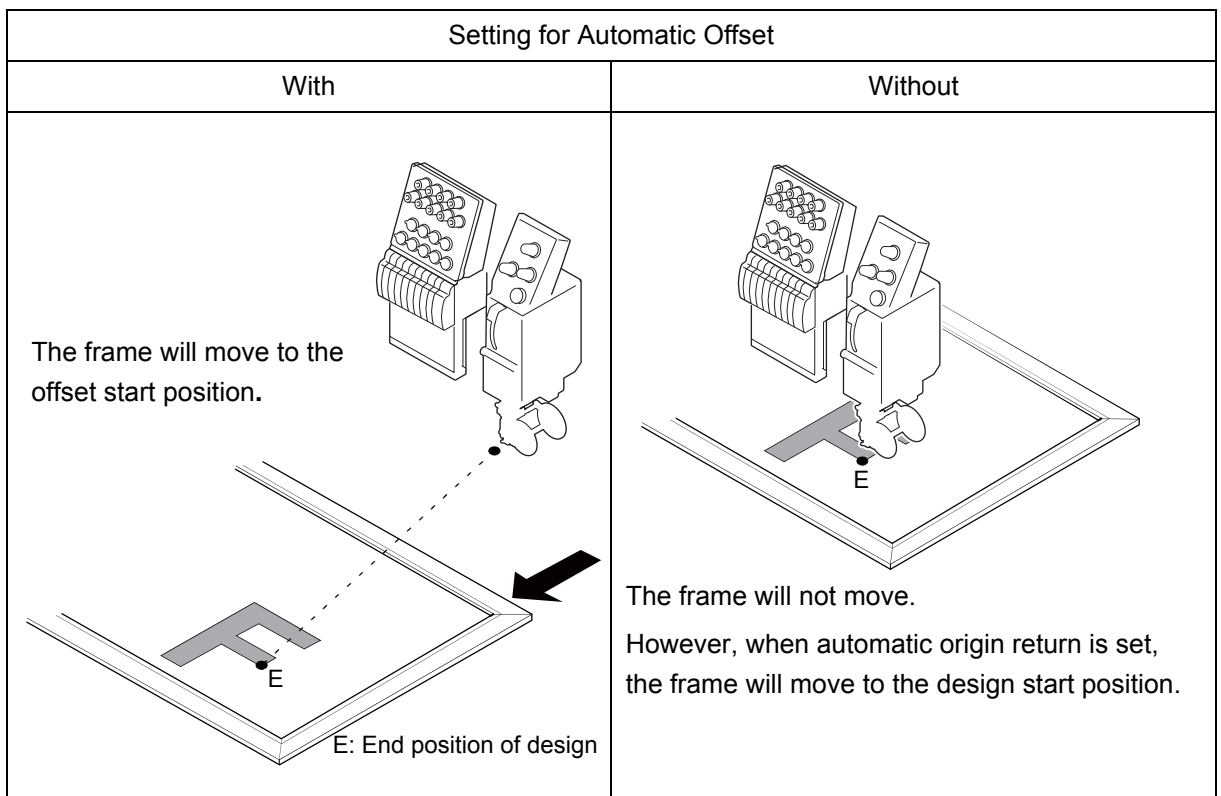

1st Edition October, 2010

7th Edition May, 2019

■ **Manufactured by : TISM Co.,Ltd.**

Address : NO.1800, Ushiyama-cho, Kasugai, Aichi-pref., 486-0901, Japan

TEL : 81-568-33-1161 FAX : 81-568-33-1191

■ **Distributed by : Tajima Industries Ltd.**

Address : NO.1800, Ushiyama-cho, Kasugai, Aichi-pref., 486-0901, Japan

TEL : 81-568-37-1130 FAX : 81-568-37-1230

●**Copy, reprint, or reform of a part or whole of this manual without permission is prohibited.**