

■ External view

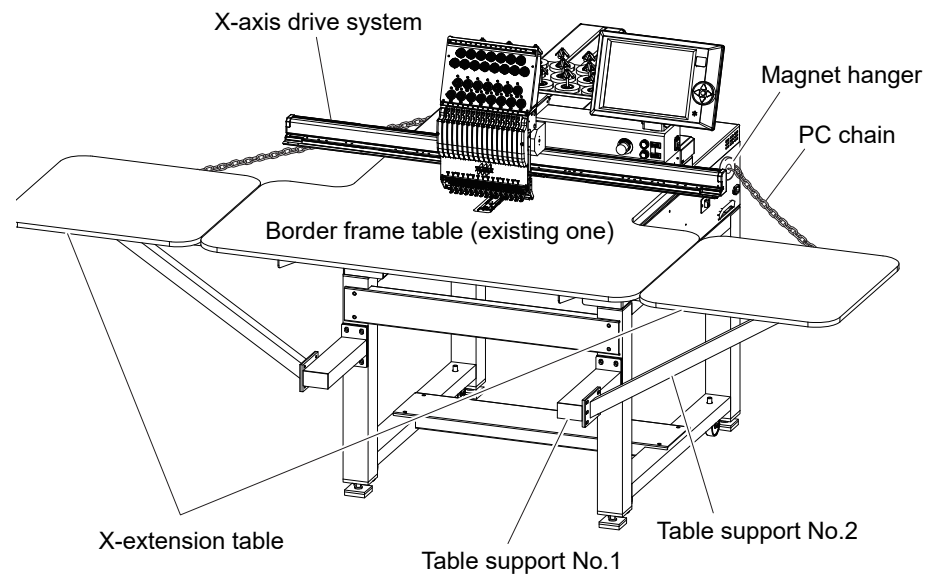

■ How to attach the X-extension table

1. Attach the border frame table to the machine.  
Refer to the separate volume "Frame Change" on how to attach the border frame table.
2. Temporarily attach table support No.1 (1) to the stand using the screws below.  
(2): Hexagon socket head cap screw M8×20  
(3): Spring washer M8  
(4): Plain washer M8×22×t3.2

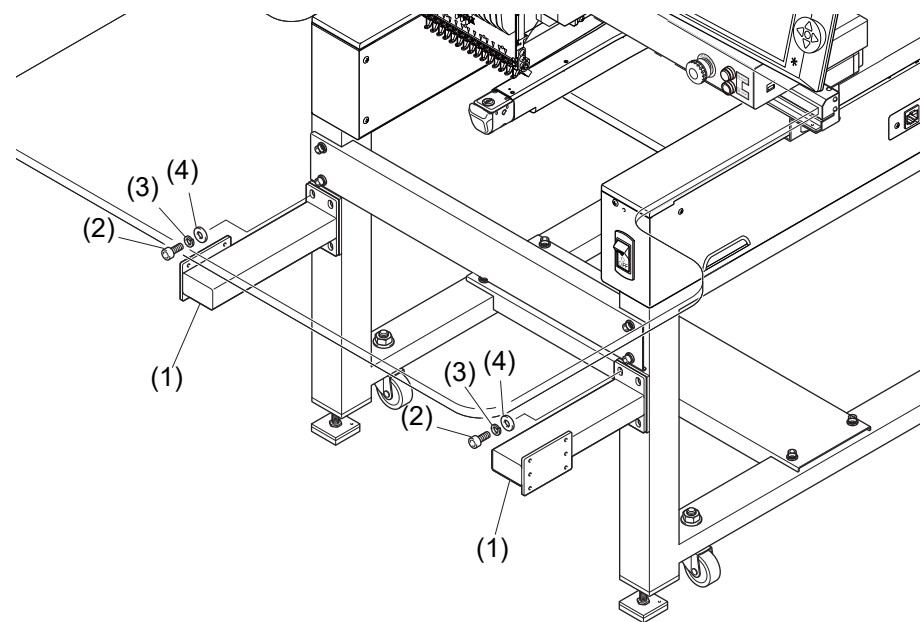

3. Temporarily attach table support No.2 (2) to table support No.1 (1) using the screws below.

- (5): Hexagon socket head cap screw M6×15
- (6): Spring washer M6
- (7): Plain washer M6×16×t1.0

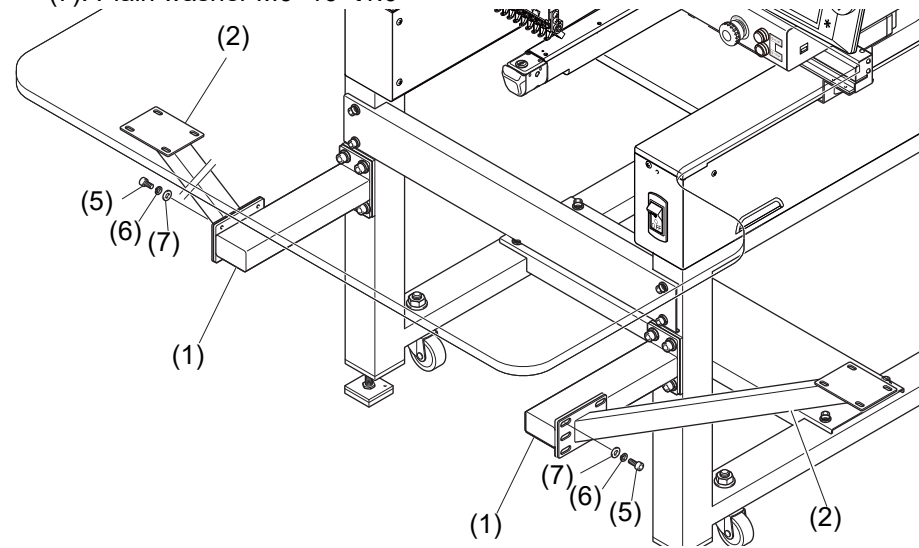

4. Attach table support No.3 (8) to the back face of the table using the screws below.

- (9): Hexagon socket head cap screw M5×12
- (10): Spring washer M5
- (11): Plain washer M5×10×t0.8

Also attach them to the opposite side.

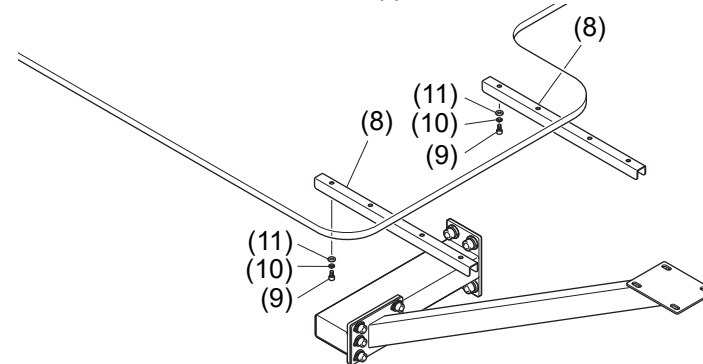

5. Attach table holder (13) to the back face of the X-extension table R (12) using the screws below.

- (14): Truss head tapping screw φ4×10
- Also attach it to the opposite side of the X-extension table L.

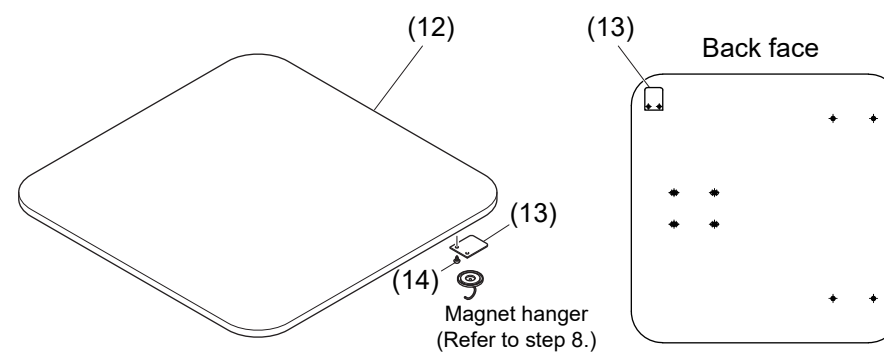

6. Put the X-extension table R (12) on table support No.3 (8) and table support No.2 (2) and fix it using the screws below.

- (9): Hexagon socket head cap screw M5×12
- (10): Spring washer M5
- (11): Plain washer M5×10×t0.8

Adjust the height of table support No.2 (2) and fix it using the screws below.

- (15): Hexagon socket head cap screw M5×15
- (16): Spring washer M5
- (17): Plain washer M5×16×t2.0

Tighten the screws which were temporarily tightened in step 2 and 3 after fixing X-extension table R (12).

Also attach the X-extension table L of the opposite side.

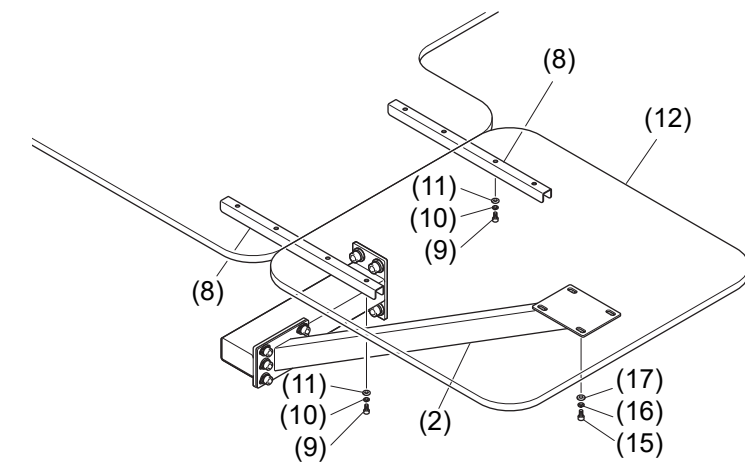

7. Check if border frame table (18) and X-extension table R and L (12) are level.

If not, adjust the attaching positions of table support No.1 (1) and table support No.2 (2)

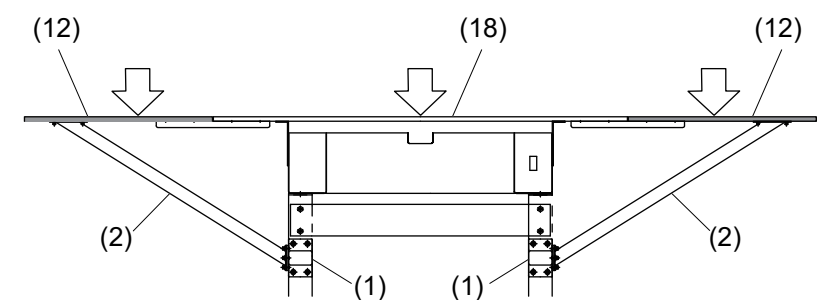

8. Attach the magnetic hanger (refer step 5) to the machine and table holder (13) to hang the PC chain referring to "■ External view".

■ Replacing the X-axis drive system

1. Remove screws (1) and remove motor cover (2) of the X-axis drive system.

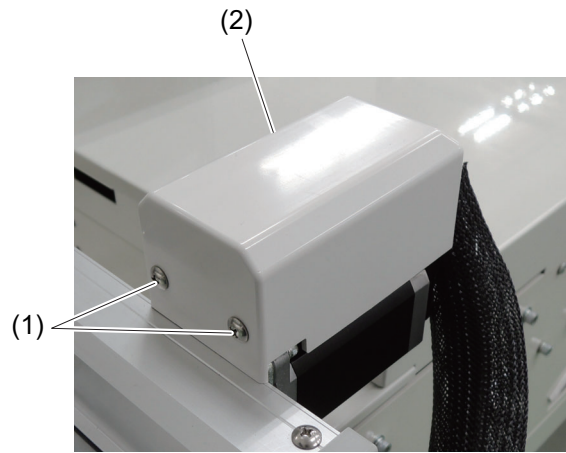

2. Remove the cable tie and disconnect three connectors (3) from the motor.

The photo below differs depending the specification. For UL, also remove the two grounding wires

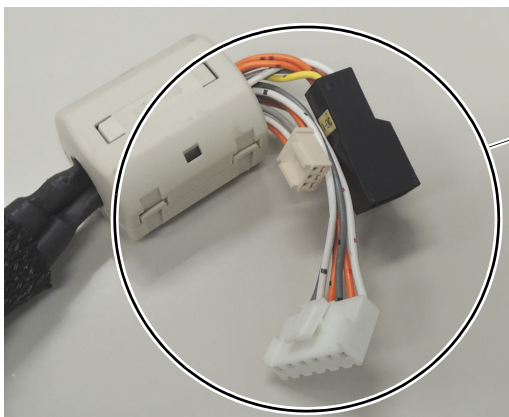
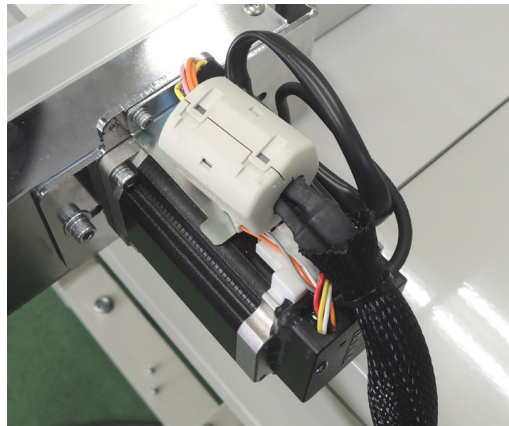

3. Remove screws (4) fixing the X-axis drive system. Also remove the opposite side screws.



4. Replace the X-axis drive system with X-extension drive system (5) and fix it using the screws removed in step 3

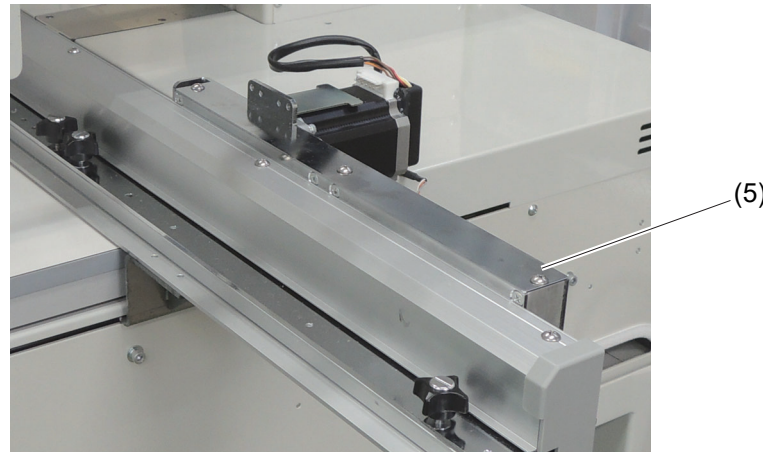

5. Connect the connectors and fix the harnesses using the cable tie.

6. Attach the motor cover (2).

**CAUTION**

Be sure to attach the motor cover (2) so that it does not contact the harnesses (6).

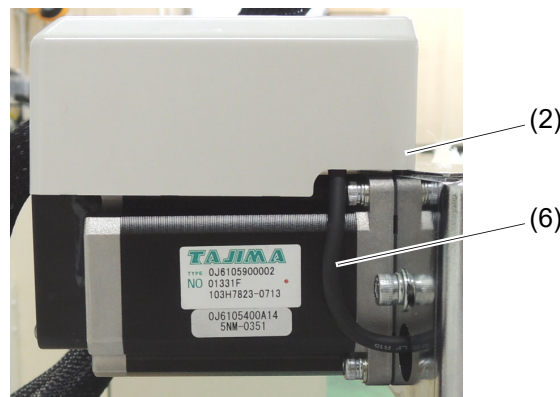

■ Changing parameter

Select "X-Ext (550x1200)" from "5 Frame type" in parameter [P1].

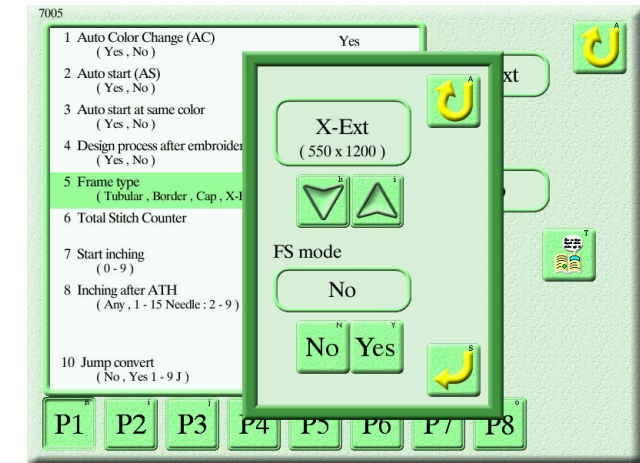

**CAUTION**

The frame that can be attached to the X-extension unit is the border frame (550 x 1200) only. If you want to attach a border frame other than this, or a cap frame or tubular frame, please replace it with a regular X-axis drive unit. Otherwise, the machine may have trouble with the sewing.